

Price and Specification Guide
11 July 2023 | Model Year 2023B



Mokka

Contents

To find the information you want use the links below to navigate around the guide:

[Vauxhall Pure Technology](#)

[Choose Your Trim Level](#)

[Range Highlights](#)

[Models](#)

[Prices](#)

[Vauxhall PureSense](#)

[Vauxhall PureConnect](#)

[Vauxhall PureEnergy](#)

[Comfort and Convenience](#)

[Safety and Security](#)

[Styling](#)

[Exterior Colours](#)

[Wheels and Tyres](#)

[Specifications](#)

[Dimensions and Capacities](#)

[Accessories](#)

[Company Car Information](#)

[Further Information](#)

Vauxhall Pure Technology

We believe technology works best when it works for everyone. When it's not just as smart as can be, but also as easy as can be. We call it Vauxhall Pure Technology. Now everyone can feel the instant excitement of electric. Everyone can keep themselves and their loved ones safe. And everyone can stay connected to the things that matter most, simply and easily. That's Vauxhall Pure Technology. No gimmicks, nothing complicated, just technology that makes driving better, easier and more exciting, for everyone.



Vauxhall PureSense

Vauxhall PureSense gives you heightened awareness on the road, with smart driver assistance technology that makes every journey safer and more enjoyable. And the best bit? You don't have to do a thing. PureSense is always on, continually working away in the background, scanning the road ahead, keeping you safe and allowing you to just enjoy the drive.



Vauxhall PureConnect

We live in a connected world. Friends and relatives are only a button away. We play music on demand. Information is instant. At Vauxhall we've brought your connected world inside the car - we call it PureConnect. Easy to use and always on, PureConnect seamlessly connects you to the things that matter through the smooth, flowing Pure Panel display. And, just as intelligently, it connects you to your car's onboard tech, through touchscreen and voice control.

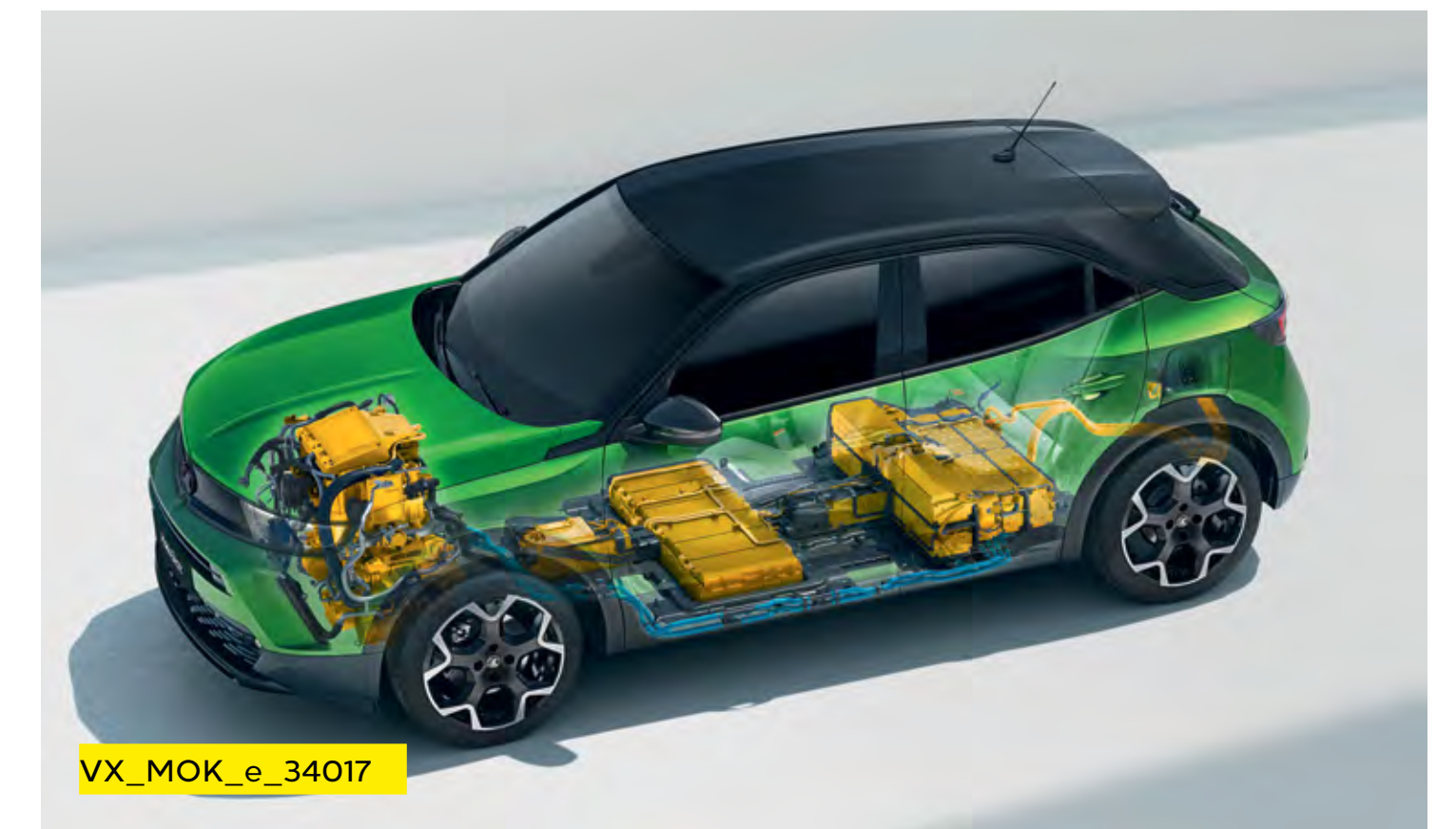

Vauxhall PureEnergy

At Vauxhall, we're on a mission to open up electric driving to everyone. To deliver instant, exhilarating performance with low emissions. To change the way we move, for the better. And with innovative Plug-in Hybrid/Electric models available across the Vauxhall range, there's an all-electric Mokka that will fit seamlessly into your life. One that's more exciting than ever, while keeping costs as low as possible. Thanks to PureEnergy from Vauxhall.

Choose Your Trim Level

Design

First in the line-up is the wonderfully well-equipped Design.



GS

This sporty number in the range comes with stylish red accents and is loaded with even more tech.

Also available as a 100% electric model.



Black

This first Special Edition Mokka has the looks and features to stand out from the crowd... also available in Black.



Ultimate

All you could ask for; our Ultimate model has it all.

Also available as a 100% electric model.



Mokka Electric Range Highlights

GS

Standard features include:

PureSense

- LED headlights and tail lights
- LED daytime running lights
- High beam assist
- Rear parking distance sensors
- Lane departure warning with lane keep assist
- Forward collision alert (low speed)
- Traffic sign recognition
- Driver drowsiness alert
- Automatic emergency braking with pedestrian detection
- Six airbags
- Hill start assist
- Remote control ultrasonic security alarm system
- Automatic lighting control with tunnel detection
- Panoramic rear-view camera

PureConnect

- Multimedia Pure Panel Navigation system
 - 10-inch colour touchscreen
 - 12-inch digital instrument cluster
 - Satellite Navigation
 - AM/FM/DAB digital radio
 - Bluetooth®
 - Apple CarPlay/Android Auto™
 - Front USB connection
 - 2 rear USB connections
- Six speakers
- Vauxhall Connect

Comfort and Convenience

- Electronic climate control
- Heated flat bottomed leather-covered steering wheel
- Heated front seats
- Electrically adjustable/heated door mirrors
- Steering wheel audio/phone/cruise controls
- Rain-sensitive windscreen wipers
- Front centre armrest with storage
- Storage pockets on front seat backs
- Automatic anti-dazzle rear-view mirror
- Keyless entry and start

Styling

- 18-inch bi-colour alloy wheels
- Red upper window moulding
- Black Griffin logo and vizor frame
- Black front/rear bumper inserts
- Black roof
- Black headliner
- Dark-tinted rear windows
- Alloy-effect sports pedals

Ultimate

Features over GS models:

PureSense

- IntelliLux LED® Matrix headlights with advanced forward lighting
- LED front fog lights
- Front and rear parking distance sensors
- Advanced park assist
- Adaptive cruise control
- Lane positioning assistant
- Forward collision alert (all speed)
- Side blind spot alert with flank guard
- Enhanced automatic emergency braking
- Automatic high beam assist
- Automatic headlight levelling system

PureConnect

- Wireless charger for mobile devices

Comfort and Convenience

- Electrically foldable door mirrors
- Alcantara interior seat trim
- Driver's side power lumbar support and massage seat
- Moveable boot floor

Styling

- Black upper window moulding

Mokka Range Highlights

Design

Standard features include:

PureSense

- LED headlights and tail lights
- LED daytime running lights • High beam assist • Lane departure warning with lane keep assist • Traffic sign recognition
- Driver drowsiness alert • Automatic emergency braking with pedestrian detection • Forward collision alert (low speed) • Cruise control with intelligent speed limiter • Six airbags • Hill start assist • Remote control central locking
- Automatic lighting control with tunnel detection

PureConnect

- Multimedia Pure Panel system
 - 7-inch colour touchscreen
 - 7-inch digital instrument cluster
 - AM/FM/DAB digital radio
 - Bluetooth®
 - Front USB connection
- Six speakers

Comfort and Convenience

- Air conditioning • Flat bottomed leather-covered steering wheel
- Electrically adjustable/heated door mirrors
- Steering wheel audio/phone/cruise controls
- Rain-sensitive windscreen wipers (auto models only) • Automatic anti-dazzle rear-view mirror (auto models only)

Styling

- 16-inch silver alloy wheels • Body coloured front/rear bumper inserts • Black painted rear spoiler • Chrome-effect upper window moulding

GS

Features over Design models:

PureSense

- Rear parking distance sensors
- Remote control ultrasonic security alarm system
- Panoramic rear-view camera
- Sports switch with engine sound enhancement

PureConnect

- Multimedia Pure Panel Navigation system
 - 10-inch colour touchscreen
 - 12-inch digital instrument cluster
 - Satellite Navigation
 - 2 rear USB connections

Comfort and Convenience

- Electronic climate control
- Heated steering wheel
- Heated front seats
- Rain-sensitive windscreen wipers (all models)
- Front centre armrest with storage
- Storage pockets on front seat backs
- Automatic anti-dazzle rear-view mirror (all models)

Styling

- 18-inch bi-colour alloy wheels
- Red upper window moulding
- Black Griffin logo and vizor frame
- Black front/rear bumper inserts
- Black roof
- Black headliner
- Dark-tinted rear windows
- Alloy-effect sports pedals

Black

Features over GS models:

PureSense

- LED front fog lights
- Front and rear parking distance sensors
- Adaptive cruise control
- Lane positioning assistant (auto models only)
- Side blind spot alert with flank guard
- Forward collision alert (all speed)
- Enhanced automatic emergency braking

Comfort and Convenience

- Electrically foldable door mirrors
- Keyless entry and start
- Moveable boot floor

Styling

- 18-inch black alloy wheels
- Black upper window moulding
- Two-coat Metallic paint

Ultimate

Features over GS models:

PureSense

- IntelliLux LED® Matrix headlights with advanced forward lighting
- LED front fog lights
- Front and rear parking distance sensors
- Advanced park assist
- Adaptive cruise control
- Lane positioning assistant (auto models only)
- Side blind spot alert with flank guard
- Forward collision alert (all speed)
- Enhanced automatic emergency braking
- Automatic headlight levelling system
- Automatic high beam assist

PureConnect

- Vauxhall Connect
- Wireless charger for mobile devices

Comfort and Convenience

- Electrically foldable door mirrors
- Alcantara interior seat trim
- Driver's side power lumbar support and massage seat
- Moveable boot floor
- Keyless entry and start

Styling

- Black upper window moulding

Mokka Electric GS



VX_MOK_34156

GS

OTR from £38,985

PureSense

- LED headlights and tail lights
- LED daytime running lights
- High beam assist
- Rear parking distance sensors
- Lane departure warning with lane keep assist
- Traffic sign recognition
- Driver drowsiness alert
- Automatic emergency braking with pedestrian detection
- Forward collision alert (low speed)
- Six airbags
- Hill start assist
- Remote control ultrasonic security alarm system
- Automatic lighting control with tunnel detection
- Panoramic rear-view camera

PureConnect

- Multimedia Pure Panel Navigation system
 - 10-inch colour touchscreen
 - 12-inch digital instrument cluster
 - Satellite Navigation
 - AM/FM/DAB digital radio
 - Bluetooth®
 - Apple CarPlay/Android Auto™
 - Front USB connection
 - 2 rear USB connections
- Six speakers
- Vauxhall Connect

Comfort and Convenience

- Electronic climate control
- Heated flat bottomed leather-covered steering wheel
- Heated front seats
- Electrically adjustable/heated door mirrors
- Steering wheel audio/phone/cruise controls
- Rain-sensitive windscreen wipers
- Front centre armrest with storage
- Storage pockets on front seat backs
- Automatic anti-dazzle rear-view mirror
- Keyless entry and start

Styling

- 18-inch bi-colour alloy wheels with red accents
- Red upper window moulding
- Black Griffin logo and vizer frame
- Black front/rear bumper inserts
- Black roof
- Black headliner
- Dark-tinted rear windows
- Alloy-effect sports pedals

Mokka Electric Ultimate



VX_MOK_e_34025

Ultimate OTR from £41,295

PureSense

- IntelliLux LED® Matrix headlights with advanced forward lighting
- LED tail lights
- LED daytime running lights
- LED front fog lights
- Automatic high beam assist
- Front and rear parking distance sensors
- Lane departure warning with lane keep assist
- Traffic sign recognition
- Driver drowsiness alert
- Enhanced automatic emergency braking with pedestrian detection
- Forward collision alert (all speed)
- Six airbags
- Hill start assist
- Remote control ultrasonic security alarm system
- Automatic lighting control with tunnel detection
- Panoramic rear-view camera
- Advanced park assist
- Adaptive cruise control
- Lane positioning assistant
- Forward collision alert (all speed)
- Side blind spot alert with flank guard
- Automatic headlight levelling system

PureConnect

- Multimedia Pure Panel Navigation system
 - 10-inch colour touchscreen
 - 12-inch digital instrument cluster
 - Satellite Navigation
 - AM/FM/DAB digital radio
 - Bluetooth®
 - Apple CarPlay/Android Auto™
 - Front USB connection
 - 2 rear USB connections
- Six speakers • Vauxhall Connect
- Wireless charger for mobile devices

Comfort and Convenience

- Electronic climate control
- Heated flat bottomed leather-covered steering wheel
- Heated front seats
- Electrically adjustable/heated/foldable door mirrors
- Steering wheel audio/phone/cruise controls
- Rain-sensitive windscreen wipers
- Front centre armrest with storage
- Storage pockets on front seat backs
- Automatic anti-dazzle rear-view mirror
- Keyless entry and start
- Alcantara interior seat trim
- Driver's side power lumbar support and massage seat
- Moveable boot floor

Styling

- 18-inch bi-colour alloy wheels
- Black upper window moulding
- Black roof • Black headliner
- Black Griffin logo and vizer frame
- Black front/rear bumper inserts
- Dark-tinted rear windows
- Alloy-effect sports pedals

Mokka Design



VX_MOK_33439

Design

OTR from £24,660

PureSense

- LED headlights and tail lights
- LED daytime running lights
- High beam assist
- Lane departure warning with lane keep assist
- Traffic sign recognition
- Driver drowsiness alert
- Automatic emergency braking with pedestrian detection
- Forward collision alert (low speed)
- Cruise control with intelligent speed limiter
- Six airbags
- Hill start assist
- Remote control central locking
- Automatic lighting control with tunnel detection

PureConnect

- Multimedia Pure Panel system
 - 7-inch colour touchscreen
 - 7-inch digital instrument cluster
 - AM/FM/DAB digital radio
 - Bluetooth®
 - Front USB connection
- Six speakers

Comfort and Convenience

- Air conditioning
- Flat bottomed leather-covered steering wheel
- Electrically adjustable/heated door mirrors
- Steering wheel audio/phone/cruise controls
- Rain-sensitive windscreen wipers (auto models only)
- Automatic anti-dazzle rear-view mirror (auto models only)

Styling

- 16-inch silver alloy wheel
- Body coloured front/rear bumper inserts
- Black painted rear spoiler
- Chrome-effect upper window moulding

Mokka GS



VX_MOK_34155

GS

OTR from £27,035

PureSense

- LED headlights and tail lights
- LED daytime running lights
- High beam assist
- Rear parking distance sensors
- Lane departure warning with lane keep assist
- Traffic sign recognition
- Driver drowsiness alert
- Automatic emergency braking with pedestrian detection
- Forward collision alert (low speed)
- Cruise control with intelligent speed limiter
- Six airbags
- Hill start assist
- Remote control ultrasonic security alarm system
- Automatic lighting control with tunnel detection
- Sports switch with engine sound enhancement
- Panoramic rear-view camera

PureConnect

- Multimedia Pure Panel Navigation system
 - 10-inch colour touchscreen
 - 12-inch digital instrument cluster
 - Satellite Navigation
 - AM/FM/DAB digital radio
 - Bluetooth®
 - Front USB connection
 - 2 rear USB connections
- Six speakers

Comfort and Convenience

- Electronic climate control
- Heated flat bottomed leather-covered steering wheel
- Heated front seats
- Electrically adjustable/heated door mirrors
- Steering wheel audio/phone/cruise controls
- Rain-sensitive windscreen wipers
- Front centre armrest with storage
- Storage pockets on front seat backs
- Automatic anti-dazzle rear-view mirror

Styling

- 18-inch bi-colour alloy wheels with red accents
- Black front/rear bumper inserts
- Black painted rear spoiler
- Red upper window moulding
- Black Griffin logo and vizor frame
- Black roof
- Black headliner
- Dark-tinted rear windows
- Alloy-effect sports pedals

Mokka Black



VX_MOK_34257

Black OTR from £27,675

PureSense

- LED headlights and tail lights
- LED daytime running lights
- LED front fog lights
- High beam assist
- Front and rear parking distance sensors
- Lane departure warning with lane keep assist
- Traffic sign recognition
- Driver drowsiness alert
- Enhanced automatic emergency braking with pedestrian detection
- Forward collision alert (all speed)
- Cruise control with intelligent speed limiter
- Six airbags
- Hill start assist
- Remote control ultrasonic security alarm system
- Automatic lighting control with tunnel detection
- Panoramic rear-view camera
- Adaptive cruise control
- Lane positioning assistant (auto models only)
- Side blind spot alert with flank guard
- Automatic headlight levelling system

PureConnect

- Multimedia Pure Panel Navigation system
 - 10-inch colour touchscreen
 - 12-inch digital instrument cluster
 - Satellite Navigation
 - AM/FM/DAB digital radio
 - Bluetooth®
 - Front USB connection
 - 2 rear USB connections
- Six speakers

Comfort and Convenience

- Electronic climate control
- Heated flat bottomed leather-covered steering wheel
- Heated front seats
- Electrically adjustable/heated/foldable door mirrors
- Steering wheel audio/phone/cruise controls
- Rain-sensitive windscreen wipers
- Front centre armrest with storage
- Storage pockets on front seat backs
- Automatic anti-dazzle rear-view mirror
- Keyless entry and start
- Moveable boot floor

Styling

- 18-inch black alloy wheels
- Two-coat Metallic paint
- Black front/rear bumper inserts
- Black painted rear spoiler
- Black upper window moulding
- Black Griffin logo and vizer frame
- Black roof
- Black headliner
- Dark-tinted rear windows

Mokka Ultimate



VX_MOK_34024

Ultimate OTR from £31,455

PureSense

- IntelliLux LED® Matrix headlights with advanced forward lighting
- LED tail lights
- LED daytime running lights
- LED front fog lights
- Automatic high beam assist
- Front and rear parking distance sensors
- Lane departure warning with lane keep assist
- Traffic sign recognition
- Driver drowsiness alert
- Enhanced automatic emergency braking with pedestrian detection
- Forward collision alert (all speed)
- Cruise control with intelligent speed limiter
- Six airbags
- Hill start assist
- Remote control ultrasonic security alarm system
- Automatic lighting control with tunnel detection
- Sports switch with engine sound enhancement
- Panoramic rear-view camera
- Advanced park assist
- Adaptive cruise control
- Lane positioning assistant (auto models only)
- Side blind spot alert with flank guard
- Automatic headlight levelling system

PureConnect

- Multimedia Pure Panel Navigation system
 - 10-inch colour touchscreen
 - 12-inch digital instrument cluster
 - Satellite Navigation
 - AM/FM/DAB digital radio
 - Bluetooth®
 - Front USB connection
 - 2 rear USB connections
- Six speakers
- Vauxhall Connect
- Wireless charger for mobile devices

Comfort and Convenience

- Electronic climate control
- Heated flat bottomed leather-covered steering wheel
- Heated front seats
- Electrically adjustable/heated/foldable door mirrors
- Steering wheel audio/phone/cruise controls
- Rain-sensitive windscreen wipers
- Front centre armrest with storage
- Storage pockets on front seat backs
- Automatic anti-dazzle rear-view mirror
- Keyless entry and start
- Alcantara interior seat trim
- Driver's side power lumbar support and massage seat
- Moveable boot floor

Styling

- 18-inch bi-colour alloy wheels
- Black painted rear spoiler
- Black upper window moulding
- Black roof
- Black headliner
- Black Griffin logo and vizer frame
- Black front/rear bumper inserts
- Dark-tinted rear windows
- Alloy-effect sports pedals

Mokka Electric Prices

	LCDV Code	Price (£)	VAT (£)	Total (£)	On-the-road RRP (£)	Financial Year 2023/24 BiK 20% (£)	WLTP Combined CO ₂ (g/km) - LCDV Code	Insurance Groups
GS								
Electric Propulsion (136PS) auto	1GQOSYHESFT0A032	31,691.67	6,338.33	38,030.00	38,985.00	12.98	0	21E
Ultimate								
Electric Propulsion (136PS) auto	1GQOSYRESFT0A032	33,616.67	6,723.33	40,340.00	41,295.00	13.75	0	22E

WLTP Combined CO₂ (g/km) figures are based on a configured vehicle as per LCDV code for UK with no options fitted.

Please note: On-the-road recommended retail prices (RRP) include number plates and delivery to Retailer of £900.00 (including £150.00 VAT), 12 months' Vehicle Excise Duty and new vehicle first registration fee of £55.00. Excludes fuel and insurance. Company Car Benefit in Kind (BiK) rates are monthly based on the standard paint price. Price has been calculated using manufacturer estimates. Retailers may be required to carry out more than one credit check during the course of the order process. You may be required to place a deposit when placing your order with your supplying Retailer. In the event of a price change, deposit refunds will be governed by your supplying Retailer's policy and as such must be discussed with the supplying Retailer.

Mokka Prices

	LCDV Code	Fuel Type	Price (£)	VAT (£)	Total (£)	On-the-road RRP (£)	Financial Year 2023/24 BiK 20% (£)	WLTP Combined CO ₂ (g/km)* - LCDV Code	Insurance Groups
Design									
1.2 (100PS) Turbo	1GQOSYGJLKTOA032	Petrol	19,579.17	3,915.83	23,495.00	24,660.00	117.91	124	14E
1.2 (136PS) Turbo	1GQOSYGP9KTOA032	Petrol	20,579.17	4,115.83	24,695.00	25,860.00	123.71	124	21D
1.2 (130PS) Turbo auto	1GQOSYGM61TOA032	Petrol	21,720.83	4,344.17	26,065.00	27,275.00	139.32	132	20D
GS									
1.2 (100PS) Turbo	1GQOSYHJLKTOA032	Petrol	21,558.33	4,311.67	25,870.00	27,035.00	133.85	125	15E
1.2 (136PS) Turbo	1GQOSYHP9KTOA032	Petrol	22,558.33	4,511.67	27,070.00	28,235.00	139.85	125	19E
1.2 (130PS) Turbo auto	1GQOSYHM61TOA032	Petrol	23,891.67	4,778.33	28,670.00	29,880.00	152.78	133	19E
Black									
1.2 (136PS) Turbo	1GQOSYKP9KTOD732	Petrol	22,091.67	4,418.33	26,510.00	27,675.00	137.05	125	19E
Ultimate									
1.2 (136PS) Turbo	1GQOSYRP9KTOA032	Petrol	25,241.67	5,048.33	30,290.00	31,455.00	155.95	125	20E
1.2 (130PS) Turbo auto	1GQOSYRM61TOA032	Petrol	26,575.00	5,315.00	31,890.00	33,100.00	169.42	133	20E

WLTP Combined CO₂ (g/km) figures are based on a configured vehicle as per LCDV code for UK with no options fitted.

*Fuel consumption and CO₂ figures are determined according to the WLTP test cycle. CO₂ figures, BiK values and RRP pricing shown above are for a standard vehicle without any additional optional equipment. CO₂ figures are used to calculate Vehicle Excise Duty (VED) for the first registration of the vehicle and BiK. The addition of optional extras could increase the certified CO₂ emission output. This in turn may affect the amount of VED payable upon registration, and, for company car drivers, the P11D value and the amount of Benefit in Kind (BiK) tax payable. Figures shown are for comparison purposes and should only be compared to the fuel consumption and CO₂ values of other cars tested to the same technical standard. The fuel consumption achieved, and CO₂ produced, in real world conditions will depend upon a number of factors including, but not limited to: the accessories fitted (pre and post registration); variations in weather; driving styles and vehicle load. The WLTP (Worldwide Harmonised Light Vehicles Test Procedure) is used to measure fuel consumption and CO₂ figures. Full data relating to WLTP test cycles can be found at: www.vauxhall.co.uk/wltp

Please note: On-the-road recommended retail prices (RRP) include number plates and delivery to Retailer of £900.00 (including £150.00 VAT), 12 months' Vehicle Excise Duty and new vehicle first registration fee of £55.00. Excludes fuel and insurance. Company Car Benefit in Kind (BiK) rates are monthly based on the standard paint price.

PureSense

Model specific features are outlined in the separate tabular information

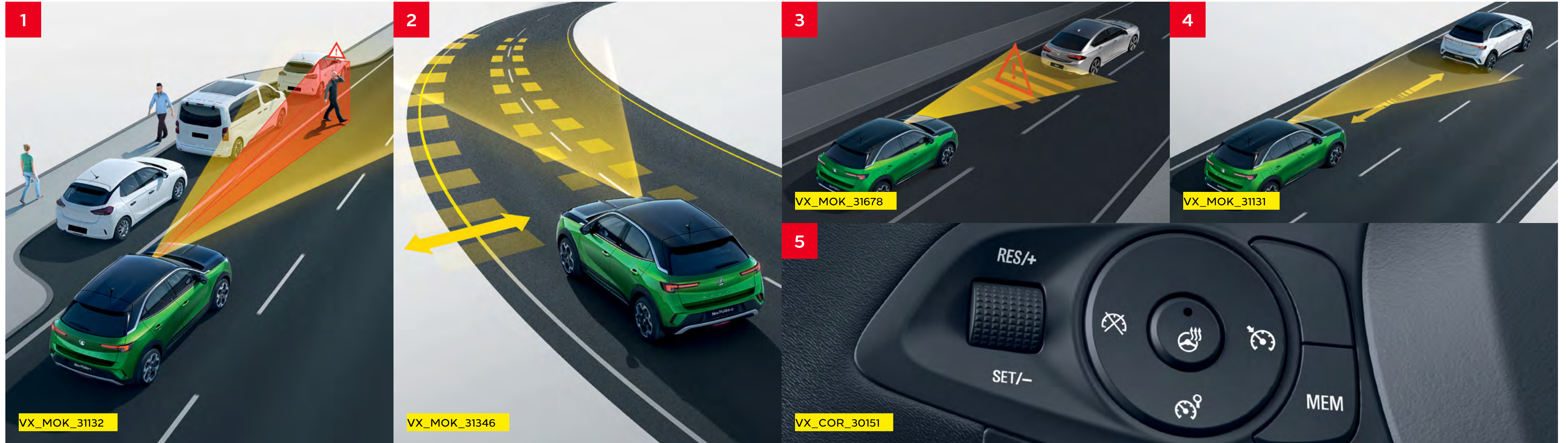

1. Automatic emergency braking with pedestrian detection

Front camera system monitors the traffic situation in front of the vehicle using the front camera to detect mobile and fixed cars as well as adult pedestrians. The system first warns you through a series of visual and audible alerts and should you not react quickly enough, will automatically brake the vehicle to avoid or mitigate the impact of front-end collisions.*

*Cycles, motorcycles, animals and other objects are not detected.

2. Front camera and radar system

Adds radar-based technology to the standard front camera system features, enabling you to avoid or mitigate the impact of front-end collisions by detecting fixed and mobile objects, such as cycles and pedestrians. The system will even bring the vehicle to a complete standstill when driving under 30mph in traffic.

3. Lane departure warning with lane keep assist

If the driver has not actively steered or signalled, the lane departure warning system warns when the car moves outside of lane markings at speeds above 37mph.

4. Adaptive cruise control

The system monitors driving time and driving behaviour to help prevent accidents caused by tiredness.

5. Cruise control with intelligent speed adaptation

Adaptive cruise control uses the radar system to adjust the vehicle's speed to maintain a safe distance from the vehicle ahead, up to the speed limit set.

4. Adaptive cruise control

Adaptive cruise control uses the radar system to adjust the vehicle's speed to maintain a safe distance from the vehicle ahead, up to the speed limit set.

Model specific features are outlined in the separate tabular information

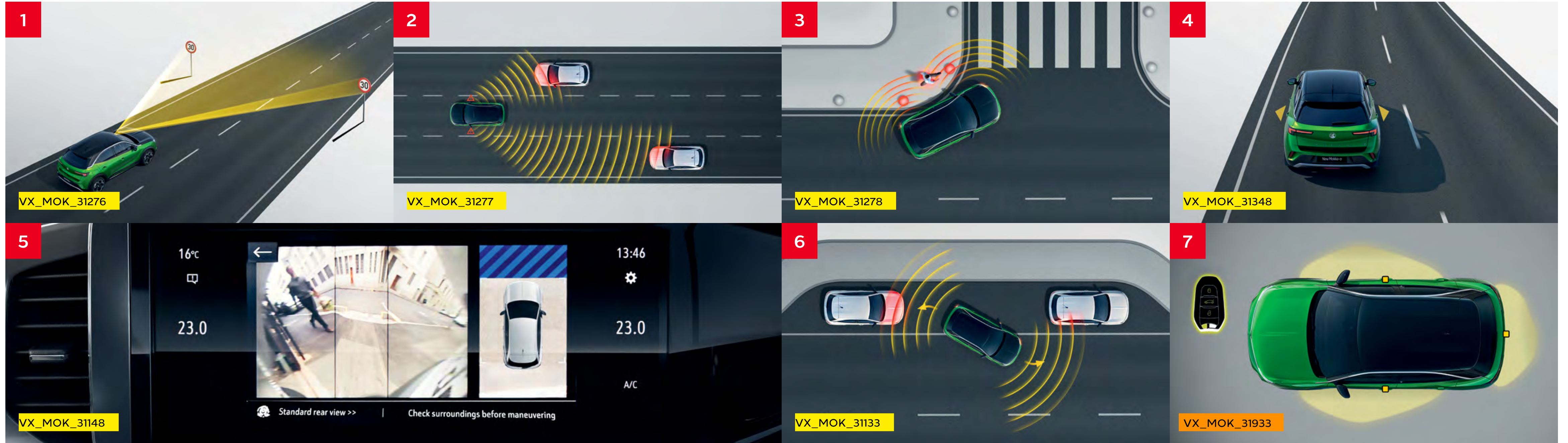

1. Speed sign recognition

Detects and then displays speed limits, reducing uncertainty and the risk of speeding.

2. Side blind spot alert

Drivers can change lanes with more confidence. It alerts the driver to vehicles in the blind spot within 3m in parallel lanes via the flashing icon in the side mirror.

3. Flank guard

Using ultrasonic side sensors, flank guard helps with manoeuvring into tight spaces, and works in conjunction with the door mirrors to help drivers avoid any side scrapes while parking.

4. Lane positioning assist

This works as a semi-automatic system that helps you integrate into a motorway lane, follow a particular lane, or follow a vehicle ahead. Engaged at the touch of a button.

5. Panoramic rear-view camera

Provides an overhead view of the area around the vehicle and displays rear cross traffic that may be approaching.

6. Front and rear parking distance sensors

Invaluable for reversing into and leaving a tight parking spot. As well as the more usual audible warning, the distance to an obstacle is displayed within the driver information screen

7. Keyless entry and start

Simply get in and start the engine without having to find the keys.

Driver drowsiness alert

Our seriously smart driver drowsiness system uses sensors to keep an eye out and warn you if you show signs of tiredness. So you'll know when it's time to stop for that all-important break. (Not illustrated).

Model specific features are outlined in the separate tabular information

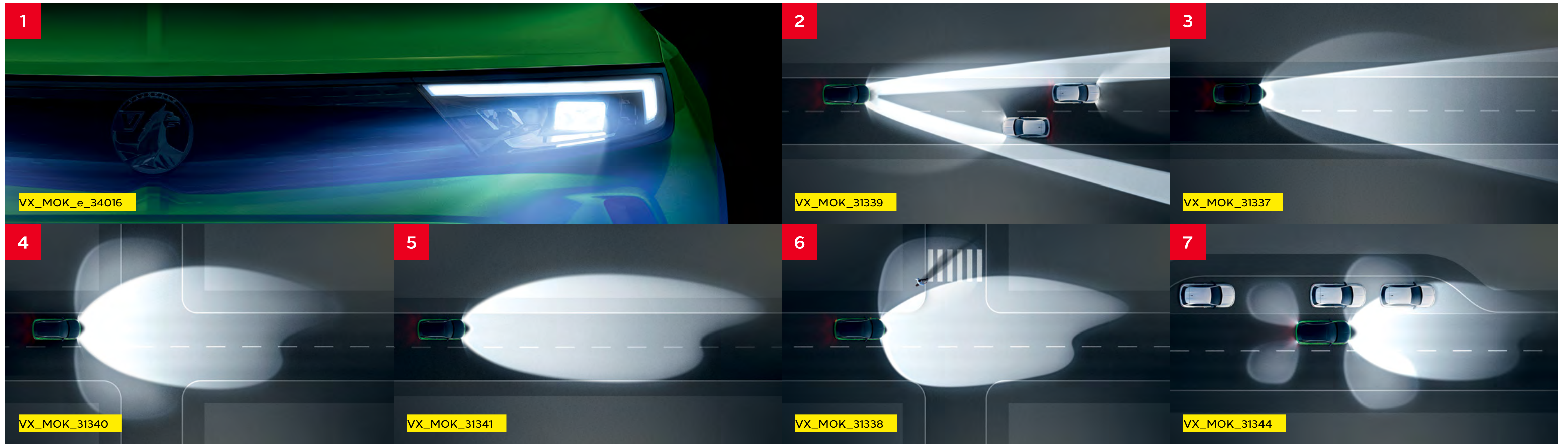

1. IntelliLux adaptive LED® Matrix headlights

Automatically adapt the headlights according to the type of road or driving conditions. There are seven variations to ensure the correct lighting pattern for driving in a city street or country lane, parking or negotiating a tight bend.

2. Anti-glare beam

Anti-glare beam is an advanced full beam that controls independent units of the IntelliLux adaptive LED® Matrix headlights.

3. Eco LED headlights with high beam assist

ECO LED headlights with high beam assist are standard on all Mokkas. The system will detect both ambient light and vehicle specific light for oncoming and leading traffic. Depending on the lighting level, the system automatically switches between high and low beam.

4. Town light

Whenever street lighting is recognised at speeds under 34mph, the system switches to an optimal town headlight setting that improves lateral vision without dazzling.

5. Country light

Country roads are illuminated, providing a wider spread and brighter light than the normal low beam. As speeds increase, so does the lighting's performance. It automatically adjusts when oncoming traffic is detected.

6. Static curve light

Provides increased light intensity light for greater visibility when negotiating high-speed bends and automatically switches beam intensity in order to avoid glaring other road users.

7. Manoeuvring mode

Manoeuvring mode provides extra light around the vehicle and is designed for parking and reversing.

Adaptive Motorway mode

Motorway mode recognizes whether the vehicle is on a motorway and responds by adapting the headlights for optimum night-time motorway driving (not illustrated).

Model Specific Features

	Electric models		Design	GS	Black	Ultimate
	GS	Ultimate				
Driver Assistance						
Cruise control with speed limiter	●	●	●	●	●	●
Automatic emergency braking with pedestrian detection	●	●	●	●	●	●
Speed sign recognition	●	●	●	●	●	●
Driver drowsiness alert	●	●	●	●	●	●
Lane departure warning with lane keep assist	●	●	●	●	●	●
Forward collision alert (low speed)	●		●	●		
Forward collision alert (all speed)		●			●	●
Lane positioning assistant		●			auto only	auto only
Adaptive cruise control		●			●	●
Side blind spot alert and flank guard		●			●	●
Enhanced automatic emergency braking		●			●	●
Rear parking distance sensors	●			●		
Front and rear parking distance sensors		●			●	●
Panoramic rear-view camera	●	●		●	●	●
Advanced park assist		●				●
Sports switch with engine sound enhancement				●		●
Exterior Lighting						
High beam assist	●	●	●	●	●	●
LED headlights, tail lights and daytime running lights	●		●	●	●	
IntelliLux Matrix LED® headlights with advanced forward lighting and anti-glare beam		●				●
Automatic lighting control with tunnel detection	●	●	●	●	●	●
LED front fog lights		●			●	●
Automatic headlight levelling system		●			●	●

Please note, Vauxhall driver assistance systems are intended to support the driver within the system-imminent limitations. The driver remains responsible for the driving task at all times.

PureConnect

Model specific features are outlined in the following pages



1. Central display

Has a multimedia system as standard with a 7-inch colour touchscreen on Design models and 10-inch on all others, both integrated seamlessly into the new Pure Panel.

2. Wireless smartphone interface

Wireless smartphone projection that allows operations via voice command, touchscreen and buttons to control apps and music playback with Apple CarPlay and Android Auto™ compatibility.

3. Instrument cluster

The driver can customise the content shown on the fully digital up to 12-inch driver information cluster by selecting via the left stalk. In addition pop-ups such as receiving calls and alerts can be displayed.

4. AGR front seats*

The AGR label confirms that the Mokka's ergonomically certified AGR seats meet even the highest levels of comfort.

5. Inductive wireless smartphone charger**

Smartphones can be charged inductively on the charging pad in the front of the centre console.

Standard Pure Panel Features – The following features are standard across the entire Mokka range. Specific features by model are outlined in the separate tabular information.

Pure Panel Digital Display

Pure Panel technology makes driving more intuitive, with a flowing design that presents the information you need. With up to a 10-inch infotainment touchscreen and 12-inch digital instrument cluster right in front of you, you can stay focused on the road ahead.

EV information display

- Powerflow display – Informs drivers on the current state of charge
- Charge display – displays an image of the charge port with the corresponding LED charge indication lights
- e-Save – enables the driver to determine how much battery energy needs to be conserved to ensure that the vehicle reaches its destination when in a zero emission zone
 There are three options:
 – 6 mile/12 mile range reserve/Maximum reserve
- Statistics – The Statistics display the average consumption data over a period of time using colour coded graphs
- **Green:** Energy recovered by braking phases and partial recharging by the petrol engine (kWh/mile)
- **Blue:** Energy consumed by the vehicle directly by the battery (kWh/mile)
- **Orange:** Fuel consumption (mpg)

Digital instrumentation

- Digital speedometer and rev counter
- Satellite Navigation display

- Digital fuel gauge with low fuel level warning light
- Digital water temperature gauge with warning light
- Shift-up/down indication light – Indicates when to change gear for optimum fuel economy

Driver information display (centrally located in digital instrument cluster)

- Total mileage • Service-due indicator
- Oil life • Tyre pressure monitoring system

Multi-function trip computer (displayed on digital instrument cluster)

- Trip mileage • Vehicle range based on remaining fuel
- Average speed • Average fuel economy
- Instantaneous fuel economy • Driving time

Digital central facia display (format dependent on infotainment unit)

- Audio information
- Digital clock with automatic RDS time adjustment
- Outside air temperature with ice warning function
- Additional features dependent on infotainment unit



Model Specific Features

	Electric models		Design	GS	Black	Ultimate
	GS	Ultimate				
Driver Information						
7-inch digital instrument cluster (centrally located in instrument panel)			●			
12-inch digital instrument cluster (centrally located in instrument panel)	●	●		●	●	●

Standard Features

Multimedia with 7-inch touchscreen

Standard on Design models

Onboard features:

- 7-inch colour touchscreen
- DAB Digital radio
- RDS with Traffic Programme
- AM/FM stereo radio with 36 station presets
- Six speakers

Media connections:

- USB connection
- Bluetooth® A2DP audio streaming (Advanced Audio Distribution Profile)

Mobile phone portal:

- Bluetooth® connectivity
- Vehicle microphone
- Handsfree calls via steering wheel controls
- Phone book access – Contacts/last calls/missed calls etc. are mirrored on the display and are easily navigated using the touchscreen (features dependent on mobile phone).
- SMS read out and reply

Smartphone interface:

- Apple CarPlay
- Android Auto™
- Smartphone projection that allows operations via voice command, touchscreen and buttons to control apps and music playback

Additional features:

- Steering wheel mounted audio controls
- Flexible roof-mounted aerial

Multimedia Navi Pro with 10-inch touchscreen

Standard on GS and Ultimate models

Standard on Mokka Electric models

Features as Multimedia, with the addition of:

- 10-inch colour touchscreen
- Satellite navigation system
- 2D/3D street level mapping
- European coverage
- Points-of-interest search
- Map updates via USB



Please note, Apple CarPlay screen illustrated on 10-inch colour touchscreen on multimedia Navi Pro audio unit.

Vauxhall Connect

Vauxhall Connect* is the new way to stay connected while on the road. Smart technology systems and related services keep our drivers safe and provide an exciting, efficient yet safe trip. Activating Vauxhall Connected Services is easy, just visit Vauxhall Connect Store or download MyVauxhall app.

Peace of mind

- Emergency call (SOS e-call)
- Breakdown call (b-call)
- Vehicle status and information**
- Maintenance alerts, fuel level, average fuel consumption and mileage



Vauxhall SOS

In the event of a breakdown or accident, you can count on Vauxhall Connect as your car has its own SIM card installed. If something happens that means there may have been an accident – say, the airbags are inflated or the pre-tensioners on the seatbelts are activated – an automatic message will go off to the emergency services, with details of your location. Vauxhall Connect SOS can be activated manually too – just press the button and you'll be put straight through to the emergency services on the system's integrated phone. So, if you have an accident, or see one, it only takes a few seconds to call for help.

Got a problem with your car but don't need the emergency services? Just press the Vauxhall Connect Assistance button and you'll be connected to our control centre over the system's integrated phone.

Convenience

- E-remote control (Mokka Electric only)**
- Remote check of battery level, programming and charge management
- Pre-conditioning of vehicle temperature



E-remote

Check and manage your electric/hybrid vehicle range remotely and in real time using your smartphone. With MyVauxhall you can check the charge and range of your vehicle at any time, and if you're plugged into a charging point, you're even able to control charging when you're far away. To offer peace of mind, you can be alerted when the battery is full or the charging is interrupted.

The remote pre-conditioning feature allows you to warm or cool the vehicle to an optimal temperature before starting your journey. With your comfort in mind, this feature allows you to maximise range if your vehicle is on charge, by taking energy from the source, rather than the battery.

Drive Smart

- Live navigation† with on-line traffic, fuel prices and parking information, Points Of Interest (POI) search and weather
- Trip and drive management**
- Timestamping of trips, trip details, last vehicle position, guide-to-car and more



Live Navigation Plus†

Vauxhall's fully integrated navigation system helps you stay informed, providing real-time information from the leading European GPS provider, TomTom®. It can be operated using natural voice recognition, meaning your eyes need never leave the road.

Vauxhall Live Navigation Plus includes:

- TomTom® services
- Real time traffic news
- Parking prices and availability
- Weather forecast on your journey
- Natural voice control
- Fuel prices at petrol stations
- Search for charging stations
- Quick search for addresses and points of interest
- Road safety alerts

PureEnergy

Model specific features are outlined in the following pages

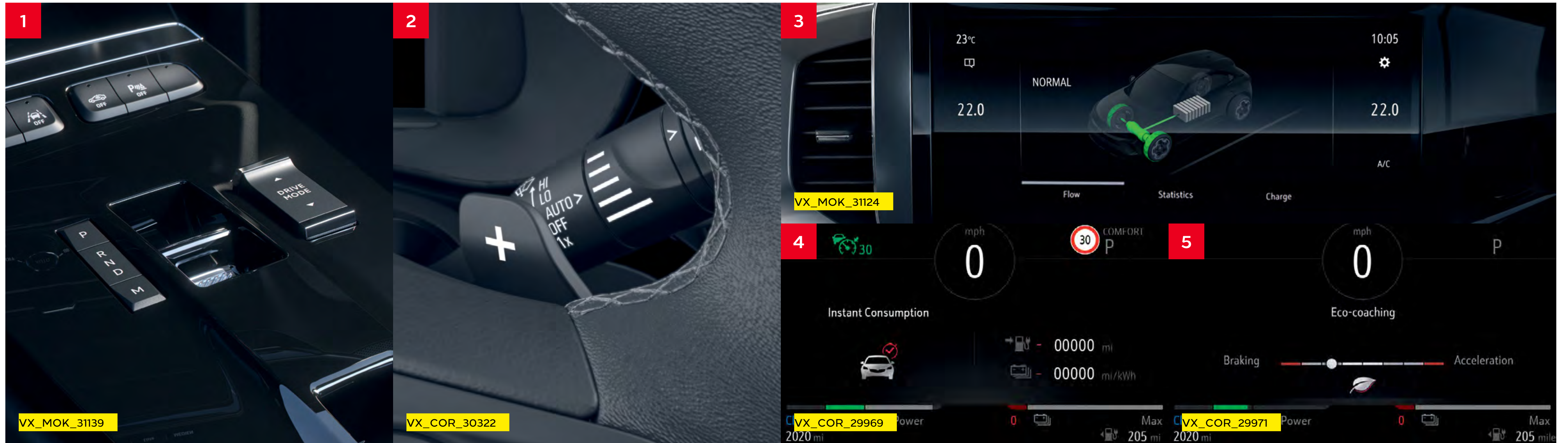

1. 8-speed automatic transmission

The sophisticated 8-speed automatic transmission on petrol models has a number of features to help improve both efficiency and improve driving dynamics:

- Reduced internal friction to improve efficiency
- A torque converter design that has been specifically engineered to improve gear shift smoothness and reduce idling vibration
- Quickshift technology that offers one of the fastest shifting on the market
- Manual shifting mode available with shift paddles

2. Three driving modes

- Normal. For a balanced drive that offers the perfect combination of performance and fuel efficiency
- Sport. That improves steering feel, sharpens the throttle response, and raises the transmission shift points for a more dynamic driving experience
- Eco. For maximum fuel economy using shorter shifting points and a slower throttle response

2. Paddle shift

Mokka petrol automatic customers can also experience a more involving driving experience by using the paddle shift levers integrated into the steering wheel; a feature normally found on larger executive sports models.

3/4/5. Electric information displays

All electric-specific data on Mokka Electric models is displayed in the infotainment system and can be accessed using the special 'EV' button on the infotainment system. The EV app includes the following submenus:

- Flow
- Statistics
- E-save

Electric vehicle services

Electric vehicle services, such as thermal preconditioning and battery charging functions, are available not just with the MyVauxhall app, but also through the infotainment system in certain cases (Not illustrated).

Mokka Electric Specifications

Single-speed electronic drive selector

As the motor is an all-electric single-speed drive unit, there is no need for multiple gears. Instead, the shifter lets the driver select from the following:

- Park
- Reverse
- Neutral
- Drive
- Braking (for increased regenerative braking)

Drive Mode Selector

The driver can determine the driving style through selecting one of the following modes:

- **Sport:** for a dynamic drive with a responsive throttle and the highest top speed and torque
- **Normal:** for a balanced drive that offers a compromise between performance and energy efficiency
- **ECO:** for maximum range and energy efficiency. The ECO mode deactivates all unnecessary energy-consuming features and reduces the top speed, torque and overall performance

Drivetrain	Mokka Electric
CO ₂ emissions	0g/km
Maximum power	100kW (136PS)
Maximum torque	260Nm (192lb. ft.)
Acceleration 0–60mph	9.2 sec
Maximum speed	93mph
Transmission	Automatic electric drive with fixed gear ratio
Service interval	Initial inspection at 8,000 miles/1 year (whichever comes sooner). Thereafter 16,000 miles/2 years (whichever comes sooner)



VX_MOK_e_34017



VX_MOK_e_33783

Mokka Electric Specifications

Charging

Mokka Electric comes fitted with an 11kW on-board charger and mode 3 cable.

The charging flap's Padlock LED lights up when the cable is correctly plugged in and locked and then acts as a user interface to show the charging status via coloured LED lights:

- **White:** welcome light that helps to light up the area, especially useful in dark conditions
- **Flashing green:** charging in progress
- **Solid green:** charging complete
- **Solid blue:** delayed charging toggled; changes to flashing green when charging commences
- **Solid red:** malfunction

The driver may also choose from two settings:

- **Immediate charging (the standard setting):** Starts charging as soon as the vehicle is docked for charging
- **Delayed charging:** This is especially useful for when cheaper electric rates are desired, e.g. charging at night. Simply enter a charging start time

Please note, EV range assumes that vehicle has been pre-conditioned prior to journey. This function can be accessed either via MyVauxhall App (standard with all Mokka Electric) or by using the Multimedia Navi Pro infotainment system.

Charging		
Supply	Socket	Charge Time (0-100%)
AC current – Domestic 3 pin socket (2.3kW)	Type 2	21h 45m
AC current – Home wallbox or public charger (7kW)	Type 2	7h 30m
AC current – Public charger (11kW)	Type 2	5h
DC current – Rapid charger (100kW)	CCS	30m (0-80%)

Battery	
Battery capacity	50kWh
AC on-board charger speed	11kW
EV range (WLTP high)	209 miles
Energy consumption (Combined low/high)	15.8-16.2kWh/100km
Battery warranty	8 years/100,000 miles/70% capacity



Comfort and Convenience

Model specific features are outlined in the separate tabular information



1. Cool and in control

Air-con is standard on all Mokka's models with most featuring electronic climate control too. Filters help to keep allergy-causing pollens and bad smells out. A multizone sun sensor adjusts to sunlight intensity and keeps the entire cabin at a steady temperature, whatever the weather outside. It's safer, too: controlled particle air recirculation prevents windows from fogging up for improved visibility.

2. Storage solutions

There's space for everything inside Mokka, with storage spots in all the right places, and a 60/40 fully folding rear seat.

3. Heated front seats

Driver and front passenger seats heat in three stages for a more efficient alternative to climate control – and a driving experience to look forward to.

4. Heated steering wheel

Within a minute, the steering wheel will warm hands, however chilly it is outside, making driving not just more comfortable but safer too, thanks to the better control it offers.

5. Puddle lights

When exiting the car, an LED light under the door mirror lights up the pathway. The mirrors fold in electrically when parking and the headlights and tail lights illuminate the way to the front door.

Model Specific Features

	Electric models		Design	GS	Black	Ultimate
	GS	Ultimate				
Interior Convenience						
Front 12-volt electrical accessory socket	●	●	●	●	●	●
Reach and rake-adjustable steering	●	●	●	●	●	●
Steering wheel mounted audio controls	●	●	●	●	●	●
Front USB connection	●	●	●	●	●	●
Rain-sensitive windscreen wipers	●	●	auto only	●	●	●
Front centre armrest with storage	●	●		●	●	●
Automatic anti-dazzle rear-view mirror	●	●	auto only	●	●	●
Storage pockets on front seat backs	●	●		●	●	●
2 rear USB connections	●	●		●	●	●
Moveable boot floor		●			●	●
Keyless entry and start	●	●			●	●
Heating and Ventilation						
Air conditioning			●			
Electronic climate control	●	●		●	●	●
Heated steering wheel	●	●		●	●	●
Heated front seats	●	●		●	●	●
Interior Lighting						
Interior courtesy light/Front map reading lights/ Luggage compartment lighting	●	●	●	●	●	●
Exterior Convenience						
Electrically adjustable/heated door mirrors	●	●	●	●	●	●
Electrically foldable door mirrors with puddle light		●			●	●

Design



Steering wheel:

- Three-spoke design
- Flat bottomed leather-covered steering wheel
- Satin chrome-effect bezel

Facia and door trim:

- Black facia with silver trim inserts
- Instrument panel bar Light Gravel
- Atlantis black trim inserts on front doors
- Chrome-effect interior door handles

Seating:

- Driver's seat (six-way adjustable):
 - Height
 - Reach
 - Backrest
- Front passenger's seat (four-way adjustable)
 - Reach
 - Backrest

Seat trim:

- Jet black fabric seat trim inserts
- Jet black fabric side bolsters

GS



Steering wheel:

- Three-spoke design
- Heated flat bottomed leather-covered steering wheel
- Satin chrome-effect bezel

Facia and door trim:

- Black facia with red trim inserts
- Instrument panel bar Light Gravel
- Atlantis black trim inserts on front doors
- Chrome-effect interior door handles

Seating:

- Driver's and front passenger's seat (six-way adjustable):
 - Height
 - Reach
 - Backrest
- Heated front seats

Seat trim:

- Minstral and Jet black fabric leather-effect seat trim inserts
- Jet black fabric side bolsters

Black



Steering wheel:

- Three-spoke design
- Heated flat bottomed leather-covered steering wheel
- Satin chrome-effect bezel

Facia and door trim:

- Black facia with silver trim inserts
- Instrument panel bar Polar Silver
- Atlantis black trim inserts on front doors
- Chrome-effect interior door handles

Seating:

- Driver's and front passenger's seat (six-way adjustable):
 - Height
 - Reach
 - Backrest
- Heated front seats

Seat trim:

- Minstral and Jet black fabric leather-effect seat trim inserts
- Jet black fabric side bolsters

Ultimate



Steering wheel:

- Three-spoke design
- Heated flat bottomed leather-covered steering wheel
- Satin chrome-effect bezel

Facia and door trim:

- Black facia with silver trim inserts
- Instrument panel bar Polar Silver
- Atlantis black trim inserts on front doors
- Chrome-effect interior door handles

Seating:

- Driver's seat (six-way adjustable):
 - Height
 - Reach
 - Backrest
- Lumbar adjustment (four-way electrical)
- Massage function
- Front passenger's seat (six-way adjustable):
 - Height
 - Reach
 - Backrest
- Heated front seats

Seat trim:

- Black Alcantara seat trim inserts
- Black premium leather-effect side bolsters

Safety and Security

Model Specific Features

Model Specific Features	Electric models		Design	GS	Black	Ultimate
	GS	Ultimate				
Security						
Remote control central locking	●	●	●	●	●	●
Remote control ultrasonic security alarm system	●	●		●	●	●
Airbags						
Driver's airbag/Front passenger's airbag/Front seat side-impact airbags/ Full-size curtain airbags	●	●	●	●	●	●
Braking						
Hill start assist	●	●	●	●	●	●
Child Safety						
Deactivation switch for front passenger's front and side-impact airbags	●	●	●	●	●	●
ISOFIX child seat mountings incorporating top tether anchor points located on outer rear seats (does not include child seat)	●	●	●	●	●	●
Child-proof locks on rear doors	●	●	●	●	●	●
Tyre Pressure						
Tyre pressure monitoring system	●	●	●	●	●	●



Hill start assist.



ISOFIX child seat mountings.



Automatic emergency braking (see PureSense page for details).

Styling

Model Specific Features

	Electric models		Design	Other models		
	GS	Ultimate		GS	Black	Ultimate
Exterior Styling						
Dark-tinted rear windows	●	●		●	●	●
Black Griffin logo and vizer frame	●	●		●	●	●
Chrome-effect Griffin logo and vizer frame			●			
Body coloured front/rear bumper inserts			●			
Black front/rear bumper inserts	●	●		●	●	●
Body-colour front and rear bumpers	●	●	●	●	●	●
Body-colour door handles	●	●	●	●	●	●
Black door mirror housings	●	●	●	●	●	●
Integrated black tailgate spoiler	●	●	●	●	●	●
Interior Styling						
Alloy-effect sports pedals	●	●		●		●



VX_MOK_e_33747

Chrome-effect Griffin logo and vizer frame.



VX_MOK_34018

Black door mirrors with puddle lights.



VX_MOK_e_34019

Rear styling.

Model Specific Features/Options

	Electric models		Design	GS	Black	Ultimate
	GS	Ultimate				
Roof Colours						
Body-coloured roof	No-cost	No-cost	●	No-cost		No-cost
Black roof (Not available with Carbon Black)	●	●		●	●	●
Window Moulding Colours						
Chrome-effect window moulding			●			
Red upper window moulding*	●			●		
Black upper window moulding**	No-cost	●		No-cost	●	●

*Not available with Iconic Green/Cosmic Red/Voltaic Blue body colours. **Standard with Cosmic Red body colour.



VX_MOK_34304

Body-coloured roof.



VX_MOK_34023

Black roof.



VX_MOK_31255

Red upper window moulding.

Exterior Colours

Arctic White (POWP)*
Brilliant paint



VX_MOK_34026

Contrast Grey (MOF4)**
Two-coat metallic paint £600



VX_MOK_34030

Voltaic Blue (MOAV)†
Two-coat metallic paint £600



VX_MOK_34027

Vulcan Grey (MOVL)††
Two-coat metallic paint



VX_MOK_34273

Carbon Black (M09V)‡
Two-coat metallic paint £600



VX_MOK_34029

Iconic Green (MOHU)†
Two-coat premium metallic paint £700



VX_MOK_34031

Cosmic Red (MOPY)**
Two-coat premium metallic paint £700







VX_MOK_34028

The colours reproduced may vary slightly from the actual paint colour. As a result they should be used as a guide only. Your Vauxhall Retailer has a comprehensive display of our paint samples.

*Standard exterior paint. **Optional at extra cost including VAT. †Optional at extra cost including VAT. Not available on GS models. ††Standard on Black models only. ‡Optional at extra cost including VAT. No-cost option on Black models.

Wheels and Tyres

		Electric models					
		GS	Ultimate	Design	GS	Black	Ultimate
 VX_MOK_31304_WR6	16-inch silver alloy wheels • 215/65 R 16 Tyres			●			
 VX_MOK_31279_RV6	18-inch bi-colour alloy wheels with red accents • 215/55 R 18 tyres	●			●		
 VX_MOK_34298_DN901	18-inch black alloy wheels • 215/55 R 18 tyres					●	
 VX_MOK_31314_RSX	18-inch bi-colour alloy wheels • 215/55 R 18 tyres	No-cost	●		No-cost		●
Provision for spare wheel fitment (spare wheel is Retailer-fit, deletes emergency tyre inflation kit)				£20*	£20*	£20*	£20*

*Optional at extra cost including VAT.

Specifications

Transmission

- Front-wheel drive
- Six-speed manual gearbox
 - Available on 1.2 (100PS) Turbo/1.2 (136PS) Turbo models.
- Eight-speed automatic transmission
 - Available on 1.2 (130PS) Turbo models.

Steering

- Single pinion electrical power steering

Brakes

- Anti-lock Braking System (ABS)
- Electronic brakeforce distribution
- Emergency brake assist
- Cornering brake control
- Straight line stability control

Petrol engines

Front ventilated discs: 283mm diameter
Rear drums: 249mm diameter

Electric engine

Front ventilated discs: 302mm diameter
Rear discs: 268mm diameter

Fuel tank capacity

- 1.2 (100PS) Turbo/1.2 (130PS) Turbo/1.2 (136PS) Turbo
44 litres (9.7 gallons)

Start/Stop technology

Mokka's Start/Stop system offers real benefits by improving fuel economy and reducing CO₂ emissions, particularly in town. It does this by automatically stopping the engine when you come to a standstill, and then restarting as you prepare to move off.

Before automatically stopping the engine a number of system checks are carried out to ensure that it is both safe and practical to do so. To ensure safety, the driver must depress the clutch pedal, shift in to neutral, and then release the clutch pedal.

System checks carried out before Auto Stop activates include:

- Start/Stop system is not manually deactivated via the facia button
- Sufficient brake vacuum is available to prevent the car rolling down an incline
- Battery is in good condition and charged
- Outside air temperature and engine temperature are above specified minima
- Electronic climate control (where fitted) is not in maximum heating or maximum cooling mode

If all of these conditions are satisfied then the vehicle will Auto Stop.

When you are ready to pull away from standstill, Auto Restart is activated by depressing the clutch pedal.

Whilst at a standstill the vehicle is continually monitored. If necessary, the engine will automatically be restarted. Conditions that would initiate an Auto Restart include:

- Low battery level
- Brake vacuum below specified minimum
- Start/Stop system is manually deactivated
- Stationary for 5.5 minutes

Effective 11 July 2023
Mokka Model Year 2023B

Petrol Engines	1.2 (100PS) Turbo	1.2 (136PS) Turbo with 6-speed manual	1.2 (130PS) Turbo with 8-speed automatic
Capacity	1199cc	1199cc	1199cc
Maximum power	100PS (75kW) @ 5500rpm	136PS (100kW) @ 5500rpm	130PS (96kW) @ 5500rpm
Maximum torque	205Nm (151lb.ft.) @1750rpm	230Nm (169lb.ft.) @1750rpm	230Nm (169lb.ft.) @1750rpm
Configuration	3 cylinders, 4 valves per cylinder, double overhead camshafts	3 cylinders, 4 valves per cylinder, double overhead camshafts	3 cylinders, 4 valves per cylinder, double overhead camshafts
Fuel/induction system	Turbocharger with intercooler. Multi-point sequential fuel injection	Turbocharger with intercooler. Multi-point sequential fuel injection	Turbocharger with intercooler. Multi-point sequential fuel injection
Emission compliance	Euro 6d (6.4)	Euro 6d (6.4)	Euro 6d
Service interval	12,500 miles or 1 year (whichever occurs sooner)	12,500 miles or 1 year (whichever occurs sooner)	12,500 miles or 1 year (whichever occurs sooner)

Effective 11 July 2023
Mokka Model Year 2023B

Performance, Fuel Economy and Emissions	Performance (manufacturer's figures)		Fuel economy mpg (litres/100km)#		CO ₂ emissions g/km#		Vehicle Excise Duty*		BiK rates from - 2023/24 tax year
	Maximum speed (mph)	Acceleration 0-60mph (sec)	Combined Low	Combined High	Combined Low	Combined High	First year rate	Standard rate	
1.2 (100PS) Turbo	116	10.6	50.5 (5.5)	51.3 (5.6)	124	125	£210	£180	30%
1.2 (136PS) Turbo	125	9.1	51.3 (5.5)	51.4 (5.5)	124	125	£210	£180	29%
1.2 (130PS) Turbo automatic	124	9.2	47.8 (5.9)	47.9 (5.9)	132	133	£255	£180	31%

Weights and Towing Data kg	Gross vehicle weight	Maximum towing weights Trailer with brakes (without brakes)
1.2 (100PS) Turbo	1700	1200 (620)
1.2 (136PS) Turbo	1715	1200 (620)
1.2 (130PS) Turbo automatic	1740	1200 (640)

#Figures shown are for comparison purposes and should only be compared to the fuel consumption and CO₂ values of other cars tested to the same technical standard. The fuel consumption achieved, and CO₂ produced, in real world conditions will depend upon a number of factors including, but not limited to: the accessories fitted (pre and post registration); variations in weather; driving styles and vehicle load. The WLTP (Worldwide Harmonised Light Vehicles Test Procedure) is used to measure fuel consumption and CO₂ figures. The CO₂ figures display a range to reflect the highest value for the highest emitting version with all available options added, through to a minimum value to represent the lowest emitting version in standard specification.

*Correct at time of publication.

Please note: Gross vehicle weight is the total permissible weight of the vehicle including passengers and their luggage. The **maximum roof rack loading** should not exceed 70kg. The **maximum towing weights** are based on the ability of the car, with two occupants of 75kg each, to restart on a 12% gradient, which is approximately 1 in 8.3, at sea level. The permitted trailer load applies up to the specified incline and up to an altitude of 1000 metres above sea level. The permissible gross train weight decreases by 10% for every 1000 metres of additional altitude. At altitudes above 1500 metres, the engine output may drop with a corresponding reduction in towing capability. Any extra weight, such as luggage or additional passengers, should be deducted from the maximum towing weight. With a trailer fully loaded, **maximum noseweight** should not exceed 55kg. Always fit Vauxhall towing attachments and accessories available from your Vauxhall Retailer. They are designed specifically for Vauxhall models and carry a 12-month guarantee. During trailer towing do not exceed a maximum speed of 60mph. This speed limit is also applicable in countries with higher permitted speeds for trailer-vehicle combinations. Pay attention to the local speed limits. For trailers with low driving stability and caravans the use of an oscillation damper is strongly recommended.

Dimensions and Capacities All measurements in mm (inches) unless stated otherwise.



Loadspace Dimensions	Mokka	Mokka Electric
Maximum length behind rear seats	667 (26.3)	667 (26.3)
Maximum length rear seats folded	1418 (55.8)	1418 (55.8)
Maximum width	1021 (40.2)	1021 (40.2)
Maximum height	780 (30.7)	780 (30.7)

Luggage Capacities – Litres (cu.ft.)	Mokka	Mokka Electric
Rear seats up (under luggage compartment cover)	350 (12.37)	310 (10.9)
Rear seats folded (to roof)	1105 (39.0)	1060 (37.4)

Accessories

Safety Total (inc. VAT)

Spare wheel kit with 16-inch emergency wheel and tool kit (petrol models only) ¹	£167
Philips ADR620 dash cam	£109
Front parking sensors	£390
Rear parking sensors	£407
Child seats ²	
- Group 0 (0-13kg) – Britax Romer Baby Safe	£239
- ISOFIX Base, Rear-facing for Britax Romer Baby Safe	£251
- Group 2/3 (15-36kg) – Britax Romer KIDFIX 2 R	£317
- Group 2/3 (15-36kg) – Britax Romer KIDFIX XP	£352
- Group 3 (22-36kg) – Booster Seat without Seatback	£76
Safety Pack – first aid kit, hi-vis vest and warning triangle	£16
Warning triangle	£9
Hi-vis safety vest – adult	£4
Hi-vis safety vest – child 3-6 years (42cm)	£4
Hi-vis safety vest – child 7-12 years (52cm)	£4
First aid kit	£15
Emergency seat belt cutter and hammer	£19
Fire extinguisher (1kg) with strap	£33
Under seat bracket for fire extinguisher	£48

Protection Total (inc. VAT)

Floor mats (set of 4)	
- Carpet	£43
- Rubber	£53
- Velour	£74
Rear seat cover	£40
Boot area cover	£54
Reversible boot tray	£81
Rear bumper protection	£100
Front and rear splash guards ³	£100

Comfort

USB charger – 2 front and 2 rear ports	£28
FlexConnect bracket	£20
FlexConnect hook	£37
FlexConnect coat hanger	£41
FlexConnect folding table	£102
FlexConnect iPad Mini holder	£127
FlexConnect iPad holder	£106
FlexConnect iPad Air holder	£106
FlexConnect Samsung Galaxy 10.1 holder	£127
Rear cup holder	£56
Cupholder organisers	£8-10
Smoker's pack	£53
Fragrance diffuser	£24
Fragrance cartridge	£18
Wireless phone charger	£171

Style Total (inc. VAT)

Stainless steel door sill covers (front)	£41
Sport pedal covers – Auto	£44
Sport pedal covers – Manual	£63
Exterior door mirror covers	
- Various colours	£111
Rear-view mirror cover ⁴	
- Various colours	£64
Decal kit with roof and bonnet racing stripes	
- Black	£244
- White	£271
Decal kit with side stripes	
- Black	£222
- White	£256
18-inch diamond-cut bi-colour alloy wheels	
- Set of 4	£1,377
Alloy wheel inserts ⁵ – various colours	
- Set of 4	£32-36
- Each	£20
Alloy wheel centre caps ⁵ – various colours	£15
Chrome valve caps	£10

Transport solutions Total (inc. VAT)

Towing	
Tow bar with removable tow ball and 13-track wiring loom ⁶	£827
Towing harness socket adaptor (13- to 7-pin)	£30

Electric

Mode 2 emergency charging cable (Type G – UK domestic plug)	£584
Mode 3 charging cable	
- 7.4kW	£331
- 11kW	£371
- 22kW	£438
Cable bag	£49
Mode 2 Universal Charger UK kit (22kW)	£1,555
Accessories for Universal Charger	
- Wall bracket	£105
- Bag	£65
- Safety lock	£20
- Adapter Type 2	£318
- Adapter Type 3c	£358
- Adapter (various)	£120

Please note: Prices shown are fully fitted and painted, where applicable and include VAT. Please check with your local Vauxhall Retailer for details. It is advisable to ensure your insurance policy is adequate to cover additional fitted accessories. Prices correct at time of publication.

¹Vehicle must be ordered with spare wheel fixing option (T7Y) in order to accommodate the spare wheel. ²Restrictions apply to the use of child seats, please consult your vehicle user manual or Vauxhall Retailer. ³Side steps and splash guards are not available together.

⁴Only available with anti-dazzle rear-view mirror. ⁵Only for use with 18-inch diamond-cut alloy wheels. ⁶Available on petrol models only.

Company Car Driver and Fleet Information

Benefit in kind company car taxation*

The car benefit charge will be the car's list price (including VAT, options and accessories fitted, delivery to Retailer and number plates, but excluding Vehicle Excise Duty and new vehicle first registration fee) multiplied by the percentage charge for the CO₂ emissions band in which the car falls (see table opposite). Multiply this figure by your personal income tax rate (20%** for Basic Rate, 40%** for Higher Rate) to calculate your annual benefit in kind tax liability.

Generic example:

ELECTRIC vehicle: 0g/km CO₂

On-the-road RRP	£27,305.00
Deduct: Vehicle Excise Duty	£0.00
New vehicle first registration fee	-£55.00
Effective list price	£27,250.00
Add: Optional two-coat metallic paint	£600.00
List price for tax purposes (P11D value)	£27,850.00
Car benefit charge 2023-24 tax year (2%)	£557.00
Benefit in kind tax liability	
Basic Rate (20%) tax payer	£111.40
Higher Rate (40%) tax payer	£222.80

*Please note this Price Guide provides taxation information as a guide only. Vauxhall does not provide taxation guidance. Drivers should always take professional advice on their own tax position.
**Excludes residents of Scotland.

BiK for Scottish Residents

Effective 6 April 2018 the Scottish Government have introduced their own BiK taxation structure. This only applies to Company Car Drivers that are Scottish taxpayers. HMRC will determine whether or not an individual is a Scottish taxpayer based on where their main place of residence is.

The BiK rates for Scotland are:

- Over £12,570 - £14,732 Starter Rate 19%
- Over £14,732 - £25,688 Basic Rate 20%
- Over £25,688 - £43,662 Intermediate Rate 21%
- Over £43,662 - £150,000 Higher Rate 41%
- Above £150,000 Top Rate 46%

CO ₂ emissions (g/km)	Percentage of cars price to be taxed 2023-24 tax year
Up to 50	14%
51 - 54	15%
55 - 59	16%
60 - 64	17%
65 - 69	18%
70 - 74	19%
75 - 79	20%
80 - 84	21%
85 - 89	22%
90 - 94	23%
95 - 99	24%
100 - 104	25%
105 - 109	26%
110 - 114	27%
115 - 119	28%
120 - 124	29%
125 - 129	30%
130 - 134	31%
135 - 139	32%
140 - 144	33%
145 - 149	34%
150 - 154	35%
155 - 159	36%
160 - 164	37%
165 - 169	37%
170+	37%

CO ₂ emissions (g/km)	Electric range (miles)	Percentage of cars price to be taxed 2023-24 tax year
0	-	2%
1 - 50	130+	2%
1 - 50	70 - 129	5%
1 - 50	40 - 69	8%
1 - 50	30 - 39	12%
1 - 50	<30	14%

To calculate your own personal liability, search: **Vauxhall BiK**, or click the link below:
[Vauxhall BiK Tool](#)

Fleet Toolbox

Discover the facts in our online Toolbox for both Company Car Drivers and Fleet Decision Makers. The Fleet Toolbox has a host of useful calculators, comparators, interactive listings and information.

Search Vauxhall Fleet Tools or click the link below:
[Vauxhall Fleet Tool Box](#)

Contact Vauxhall Fleet

Please contact one of our dedicated sales teams who will be happy to help with your particular enquiry.

Fleet Decision Makers

Depending on the size of your fleet of vehicles, we have a dedicated team to handle your enquiries. The lines are open Monday to Friday excluding Bank Holidays.

1-24 vehicles

Call: 0203 885 4560 (8:30am-5:00pm)
Email: enquiries@stellantis-fleet.co.uk

50+ vehicles

Call: 0203 885 4562 (8:30am-5:00pm)
Email: enquiries@vauxhallfleet.co.uk

Special Vehicles (Police, Fire and Ambulance)

Call: 01582 409999
Email: psvo@stellantis.com

For more information visit vauxhall.co.uk/fleet

Further Information

On-the-road prices

To eliminate uncertainty about hidden costs when buying a new car, Vauxhall publishes on-the-road recommended retail prices (RRP) and these are shown in the pricing tables within this price guide. These prices include VAT, number plates and delivery to Retailer of £900.00 (including £150.00 VAT), 12 months' Government Vehicle Excise Duty (see opposite for details) and the DVLA new vehicle first registration fee of £55.00.*

Please note: The on-the-road recommended retail price (RRP) does not include fuel supplied by the Retailer, motor insurance or any other goods or services supplied by agreement between the Retailer and the customer.

Price protection

Order a new Vauxhall for build in the current model year (as confirmed by your Retailer) for delivery no more than three months in advance and the price you are quoted is the price you pay. This is irrespective of any subsequent price rises between placing your order and delivery of your new car, but you must take delivery as soon as the car is available.

Please note: Vauxhall Motors Limited is not liable for price adjustments caused by Government changes in the rate of VAT (currently 20%), Vehicle Excise Duty, DVLA new vehicle first registration fee or by any other applicable legislation or regulations.

In the event of an accident

Vauxhall Accident Management helps keep you mobile following an accident. Benefits include vehicle recovery, Vauxhall-approved repairs and contacting your insurer. For more details, visit vauxhall.co.uk/AccidentManagement

LEASYS

Leasys UK

Leasys is the proud Business Contract Hire partner of Vauxhall and consequently, can provide quick vehicle delivery to keep your business mobile.

Specialised in Medium to Long-Term Leasing options and Fleet Management solutions for businesses of all sizes, [Leasys](#) lead mobility by offering sustainable and innovative solutions designed around customers, for a best-in-class experience. Their team of experts can personally support you and provide dedicated consultation.

[Leasys](#) is equally owned by Stellantis and Crédit Agricole Consumer Finance and is a member of the British Vehicle Rental and Leasing Association (BVRLA).

For further information, please contact your local Vauxhall Retailer or visit leasys.com/uk

Vehicle Excise Duty

The amount of Vehicle Excise Duty (road fund licence) payable on new cars varies depending on the level of carbon dioxide (CO₂) emissions produced by the vehicle. CO₂ emissions are measured in grams per kilometre (g/km) travelled and divided into 13 charging bands shown in the table opposite.

A 'first year rate' of Vehicle Excise Duty is payable on all new cars and in subsequent years the amount payable reverts to the 'standard rate'. Also, for vehicles with a list price over £40,000, including factory-fitted options, an additional £390 is payable for the first five years of standard rate payments.

Vehicle Excise Duty*

Band	CO ₂ emissions in grams per kilometre	First year rate Petrol	Standard rate Petrol	Standard rate Electric
A	0	£0	£0	£0
B	1 – 50	£10	£180	–
C	51 – 75	£30	£180	–
D	76 – 90	£130	£180	–
E	91 – 100	£165	£180	–
F	101 – 110	£185	£180	–
G	111 – 130	£210	£180	–
H	131 – 150	£255	£180	–
I	151 – 170	£645	£180	–
J	171 – 190	£1,040	£180	–
K	191 – 225	£1,565	£180	–
L	226 – 255	£2,220	£180	–
M	Over 255	£2,605	£180	–

*Correct at time of issue.

Further Information

Customer Care Commitment

For added peace of mind, Vauxhall has an innovative Customer Care Commitment that offers the following:

- Three-year vehicle warranty consisting of a one-year/unlimited mileage manufacturer's warranty and a second and third year manufacturer's warranty with a 60,000 miles limitation
- Vauxhall Assistance for 12 months from first registration
- Six years' body panel anti-perforation warranty

Please note: Warranty is only available on vehicles sourced from Vauxhall Motors Limited. Terms and conditions apply – please see your Vauxhall Retailer for details.

Vauxhall Assistance

Vauxhall Assistance is provided automatically with every new Vauxhall for 12 months from first registration and covers everything from accident assistance, roadside recovery and 'at home' service to flat tyres. For even more peace of mind, on fully electric models, the cover is extended* to 3 years. Even more reason for you to stay calm and let us take care of everything should the need arise. With Vauxhall Assistance help is literally just a free** phone call away, 24 hours a day, 365 days a year!

Protecting the environment

Vauxhall's commitment to the environment is demonstrated by our products' many environmental awards. For even more information on Vauxhall's efforts to achieve an environmentally sustainable future, and how to dispose of your end-of-life vehicle, see [vauxhall.co.uk/recycling](https://www.vauxhall.co.uk/recycling)

Vauxhall Care

This all-inclusive service package is available on Vauxhalls under 10 months old (from date of first registration).

This package offers complete peace of mind for the first 3 years of your Vauxhall's life with fixed monthly payments for the plan duration.

- **3 years' Vauxhall servicing** – covers first, second and third annual services. Including a brake-fluid change in the second service
- **2 years' Vauxhall Roadside Assistance** – first year from us
- **First years' MOT[†]** – free of charge by your local Vauxhall Retailer

For full terms and conditions and to sign up, visit: [vauxhall.co.uk/vauxhallcare](https://www.vauxhall.co.uk/vauxhallcare)

Vauxhall Service Club

Vauxhall Service Club is available for all Vauxhall owners, and it's free to join. Members benefit from the following:

- 15% off Vauxhall Approved Accessories
- Vauxhall's aged 2-3 Years = 15% off parts and labour
- Vauxhall's aged over 3 Years = 25% off parts and labour
- Half price MOT's (NI excluded)
- Free pre-MOT test inspection (NI only)
- Fixed price AdBlue® Refills
 - Car = £14.99
 - Van = £24.99
- Access to the Vauxhall Accident Management Programme
- Online service booking available 24/7 with servicing appointments available within 3 days – [Book Online](#)
- Collection and delivery/onward mobility options
- Complimentary 'Wash and Vac' with all routine services^{††}
- Vauxhall trained technicians
- Genuine Vauxhall parts
- Minimum 12 months warranty on parts and labour
- Regular newsletters with exclusive offers, discounts and competitions

Terms and conditions apply. To join visit: [vauxhall.co.uk/serviceclub](https://www.vauxhall.co.uk/serviceclub)

Vauxhall Insurance with added reassurance

Comprehensive cover – Summary of benefits

- Competitive premiums
- Repairs by a Vauxhall-trained technician
- Genuine Vauxhall parts, guaranteed for five years when we repair your car within our Approved Repairer Network
- Free courtesy car as standard when using an Approved Repairer[‡]
- 24 hour claims helpline
- Personal Accident benefit
- Cover for audio equipment
- Windscreen cover

Call for a quote on **0330 678 1130^{††}**

For more product information

For further information on the Vauxhall range or location of your nearest Vauxhall Retailer please call **0800 026 0034**. Alternatively, details can be found on our website at [vauxhall.co.uk](https://www.vauxhall.co.uk)

For more information call **0800 026 0034**

For Fleet enquiries call **0203 476 2268**

Discover the full Vauxhall range at **[vauxhall.co.uk](https://www.vauxhall.co.uk)**

Join us online

The invoice price, including delivery to Retailer, factory-fitted options, accessories fitted by the Retailer and number plates, is subject to VAT. Some feature descriptions in this guide may refer to, and some illustrations may show, optional equipment not included in the standard delivery. The information contained in this guide was accurate at the time of publication. We reserve the right to make changes in design and equipment. Please note that Vauxhall Retailers are not the agents of Vauxhall Motors Limited and are not authorised to bind Vauxhall Motors Limited by any specific or implied undertaking or representation. It is advisable to ensure that your motor insurance policy provides adequate cover for additional fitted options and accessories. The colours in this guide are only approximate actual colours. Illustrated optional equipment is available at extra charge. Availability, technical features and equipment provided on our vehicles can vary by model. For precise information on the equipment provided on our vehicles, please contact your local Vauxhall Retailer.

VAUXHALL