

# Vivaro

Passenger Carriers 2011 Models Edition 2



Proud Sponsor of Home Nations Football



# The Wheels of Business. Helping you deliver.

Whatever your line of business, Vauxhall Commercial Vehicles can help you deliver. With five different models – including New Corsavan and the award-winning New Movano – we offer a massive choice of over 230 variants including panel vans, chassis cabs,

chassis crew cabs, platform cabs, tippers, dropsides, box vans and passenger carriers. We're also committed to keeping your business moving. That means reliable, fuel-efficient vehicles – including our new ecoFLEX range – supported by a dedicated network of over





450 retailers offering the expert support and back-up you need. We build more commercial vehicles at our British production facilities at Ellesmere Port and Luton than any other UK manufacturer. We've also won over 30 industry awards since 2001 – major awards,

presented by some of the toughest judges in the business. Introduce the in-built reassurance of the Vauxhall brand and it's easy to see why Vauxhall Commercial Vehicles really are 'The Wheels of Business'.





06 Cabin interior  
08 Power and efficiency  
10 9-seat Combi

12 Doublecabs  
14 Colours and trims  
16 Technical data and equipment





## Carrying you there in style

With a stylish facia, intuitive cabin ergonomics and intelligent storage features, Vivaro passenger carriers deliver practical solutions to a variety of transport applications.

Whether you choose the Vivaro 9-seat Combi, or the Doublecab, both models combine spacious travel with high levels of passenger comfort, access and safety.

Under the bonnet, the efficient common rail diesel range comprises of cost-effective 90PS and 115PS 2.0CDTI 16v units and a powerful 146PS 2.5CDTI engine.

Introduce 20,000 mile/one-year service intervals and a warranty up to three years/100,000 miles, and you have a passenger carrier range that's guaranteed to go the distance.

*Please consult your Vauxhall Commercial Vehicle retailer for more information regarding the current availability of the audio units featured in this brochure.*

*Some of the vehicles shown in this brochure include options and accessories available at extra cost. And not all of the features described are available on every model. So please check the equipment and technical data section for further details. From time to time, we also offer alternative models such as Special Editions which are featured in separate literature or can be found on the Vauxhall website: [www.vauxhall.co.uk/vans](http://www.vauxhall.co.uk/vans)*

*Vivaro Combi SWB model illustrated features Vision Pack, glazed twin rear doors, 16-inch alloy wheels and two-coat pearlescent paint, optional at extra cost.*

# Cabin

As existing drivers will testify, Vivaro's interior raises the bar for passenger carriers in this class. There's the stylishly appointed fascia and centre console – creating the perfect driving environment. An effect that's set off by hard-wearing cloth or grey vinyl seat trim.

Not to mention the plenty of storage space for all your drinks, bags, CDs and other stuff.



**Steering column audio controls**  
Standard on all Vivaro passenger carriers, enabling you to operate audio functions.



**Intelligent storage**  
A moulded recess above the glovebox creates additional storage space.



**Satellite navigation**  
Optional TomTom-based system features a useful fascia mounted/hand-held remote control unit.



**Optional cruise control**  
Helps you keep to prevailing speed limits and can also help improve fuel economy.

## Features include:\*

- › Six-way adjustable driver's seat
- › Dual passenger bench seat
- › Facia-mounted drinks holder
- › CD player/MP3 format/stereo radio (CD 10 MP3)

## Options include:\*

- › Front passengers' twin airbag
- › Driver's seat with lumbar adjustment and armrest
- › Driver's seat and single front passenger's seat with lumbar adjustment and armrest
- › Air conditioning
- › CD player/MP3 format/stereo radio/Bluetooth® (CD 30 BT)
- › Sat Nav/CD player/MP3 format/stereo radio/Bluetooth® (CD 30 BT NAVI)
- › Solar Reflect® windscreen

\*Not all features and options are available on every model. Please see pages 16-19 for details.





*Vehicle illustrated features optional audio unit with Bluetooth® connectivity.*

# Power and efficiency

With state-of-the-art, highly efficient turbo diesel engines allied to a generous 90-litre fuel tank, Vivaro passenger carriers are designed to spend more time on the road. Equally at home around town or on longer motorway runs, they match effortless cruising ability with optimum driveability in stop-start traffic, ensuring that driver and passengers always arrive relaxed and refreshed, no matter what the driving conditions.

Renowned for their strong power outputs and flexibility, Vivaro's common rail units combine impressive performance with plenty of low-end torque – a major consideration when transporting up to nine occupants.

Fuel economy is another strongpoint; for example in October 2009, Vivaro scooped top spot in the ALD Automotive/TOTAL ECO 10 MPG Marathon, averaging an incredible 55.25mpg over a 360 mile trip.

From an operating perspective, 20,000 mile/one-year service intervals, a 'long-lasting' stainless steel exhaust system and a comprehensive 100,000 mile warranty mean more drivetime – and less downtime.



## Tecshift

Combines the flexibility of automatic transmission with the performance and control of a manual gearbox.



## More efficient

Light controls and smooth power delivery mean greater operating efficiency.

## Choice of engines:

- > 2.0CDTI (90PS) engine
- > 2.0CDTI (115PS) engine
- > 2.5CDTI (146PS) engine

## Features include:\*

- > Six-speed manual gearbox
- > Tecshift six-speed transmission with sequential manual gearshift and automatic mode
- > Power-assisted steering
- > Cruise control

\*Not all features and options are available on every model. Please see pages 16-19 for details.





Power and efficiency

*Vivaro Combi SWB model illustrated features Vision Pack, 16-inch alloy wheels and two-coat metallic paint, optional at extra cost.*





# 9-seat Combi

Perfect for hotels, businesses, airports and hire companies, the Vivaro 9-seat Combi is one of the most versatile vehicles around. It combines stylish good looks with the ability to carry up to eight passengers plus driver, in a high degree of safety and comfort.

Available in a choice of short or long wheelbase models, Combi provides generous accommodation allied to massive luggage space, thanks to an ingenious fold-and-stow facility on the third row of seats. This creates additional space for suitcases, packages and business equipment – without removing the seats.



## 9-seater comfort

With all seats in place, Combi offers comfortable transport for nine, plus the added reassurance of inertia-reel lap and diagonal seatbelts for every occupant.

Further ensuring long-distance comfort for every rear passenger, Combi features full-length headlining and half-height panelling as standard, plus optional sliding side door windows.

The 60/40 split-folding second-row seat back, passenger assist grab handles and twin sliding doors – also standard – make entry and exit a simple proposition. While for maximum ease of use, both models feature a high-lift tailgate, the long wheelbase version adding a removable luggage cover for optimum security.



**Second-row split-folding rear seat**  
The easy-to-operate 60/40 split-folding seat back allows convenient access for third-row passengers.



## Features include:\*

- › Tailgate with heated window and wash/wipe facility

## Options include:\*

- › Rear parking distance sensors
- › Remote control ultrasonic security alarm system
- › Selective door locking

*\*Not all features and options are available on every model. Please see pages 16-19 for details.*





# Doublecab

Providing practical and comfortable crew transport whoever you're carrying, the Vivaro Doublecab models match serious six-seat accommodation with excellent loadspace (up to 4.2 cu.m) and particularly generous payloads (up to 1148kg).

For added versatility, the latest Vivaro Doublecab models are available in either short or long wheelbase versions – each attractively styled to enhance the image of your business. Sportive versions take things a whole stage further with front fog lights, 16-inch alloy wheels and body-colour rear light mouldings/door mirror housings now added as standard.



## Sliding side-access doors

Access to Doublecab models is easy through the nearside and offside sliding side-access doors. Both doors feature sliding windows for optimum passenger comfort.

Contributing to comfort, all Doublecab models feature a contoured rear bench seat for three passengers. The travelling environment is enhanced by audio equipment that includes the CD 10 MP3 CD player with MP3 and stereo radio.

Twin sliding side-access doors ensure easy passenger access, while the high-strength ABS plastic bulkhead – standard on all versions – features an integral window. Rear seat passengers also benefit from excellent leg room and seat backs that are raked for comfort.



## Rear seats

Individually contoured rear bench seat accommodates up to three passengers in comfort.



## Room in the rear

Additional loadspace under the rear bulkhead extends the load area length.

## Features include:\*

- › Dual front passengers bench seat
- › CD player/MP3 format/stereo radio (CD 10 MP3)
- › Solar Reflect® windscreen

## Options include:\*

- › Rear parking distance sensors
- › Sat Nav/CD player/MP3 format/stereo radio/Bluetooth® (CD 30 BT NAVI)

## Additional Sportive features include:\*

- › CD player/MP3 format/stereo radio/Bluetooth® (CD 30 BT)
- › Air conditioning
- › Remote control security alarm system
- › 16-inch alloy wheels

*\*Not all features and options are available on every model. Please see pages 16-19 for details.*

# Colours and trims

Vivaro's business-like appearance is exemplified by the impressive choice of colours available. The cloth or vinyl trims have been chosen as much for their hard-wearing properties as they have for their visual appeal.

Corn Yellow – solid



Flame Red – solid



Glacier White – solid



Ink Blue – solid



Ocean Green – metallic



Sage – metallic



Star Silver – metallic



Steel Grey – metallic



Adria – pearlescent



Midnight Black – pearlescent



Panorama Blue – pearlescent



Winterwind – pearlescent







**Dark Grey Punch cloth**  
 Hard-wearing Dark Grey Punch cloth trim is fitted as standard across the range.

| Exterior colours            | Combi | Doublecab | Sportive Doublecab |
|-----------------------------|-------|-----------|--------------------|
| <b>Solid</b>                |       |           |                    |
| Corn Yellow                 | •     | •         | -                  |
| Flame Red                   | •     | •         | -                  |
| Glacier White               | •     | •         | •                  |
| Ink Blue                    | •     | •         | -                  |
| <b>Two-coat metallic</b>    |       |           |                    |
| Ocean Green                 | ○     | ○         | -                  |
| Sage                        | ○     | ○         | -                  |
| Star Silver                 | ○     | ○         | •                  |
| Steel Grey                  | ○     | ○         | •                  |
| <b>Two-coat pearlescent</b> |       |           |                    |
| Adria                       | ○     | ○         | -                  |
| Midnight Black              | ○     | ○         | •                  |
| Panorama Blue               | ○     | ○         | -                  |
| Winterwind                  | ○     | ○         | •                  |

- = Available at no cost.
- = Available at extra cost.
- = Not available on this model.

*Due to the limitations of the printing process the colours reproduced may vary from the actual colour. As a result they should be used as a guide only. All Vauxhall Commercial Vehicle retailers have a comprehensive showroom colour display, with actual exterior paint samples available for inspection. Please note: Certain alternative colours are available for special order on Vivaro. Restrictions apply so please consult your Commercial Vehicle retailer for more details.*

## Model availability

### Combi SWB

2.0CDTI 16v (90PS)

### Combi LWB

2.0CDTI 16v (115PS)

2.0CDTI 16v (115PS) Tecshift

### Doublecab SWB

2.0CDTI 16v (90/115PS)

2.5CDTI 16v (146PS)

2.0CDTI 16v (115PS) Tecshift

2.5CDTI 16v (146PS) Tecshift

### Doublecab LWB

2.0CDTI 16v (90/115PS)

2.5CDTI 16v (146PS)

2.0CDTI 16v (115PS) Tecshift

2.5CDTI 16v (146PS) Tecshift

### Doublecab Sportive SWB

2.0CDTI 16v (115PS)

2.5CDTI 16v (146PS)

2.0CDTI 16v (115PS) Tecshift

2.5CDTI 16v (146PS) Tecshift

### Doublecab Sportive LWB

2.0CDTI 16v (115PS)

2.5CDTI 16v (146PS)

2.0CDTI 16v (115PS) Tecshift

2.5CDTI 16v (146PS) Tecshift

## Combi 9-seat SWB

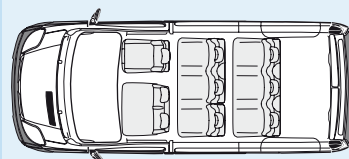
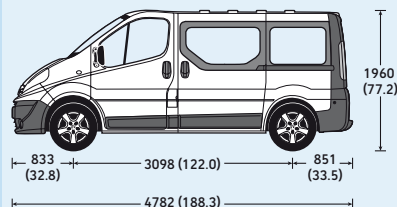

## Combi 9-seat LWB

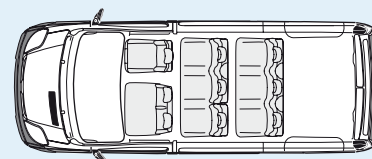
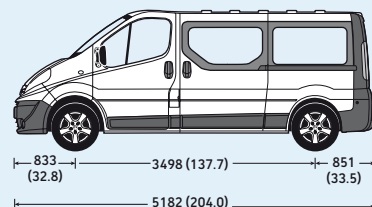

Measurements are shown in millimetres (inches). Height shown unladen.

## Combi highlights\*

- Driver's airbag
- Inertia-reel lap and diagonal seatbelts
- Anti-lock Braking System (ABS)
- Emergency Brake Assist (EBA)
- Remote control central deadlocking
- Removable luggage cover (LWB models)
- Rev counter
- Steering column adjustable for reach
- Facia-mounted gear lever
- CD player with MP3 format/stereo radio/auxiliary-in socket/integrated display (CD 10)
- Steering column mounted audio controls
- Six-way adjustable driver's seat
- Dual front passengers' bench seat
- Second-row nearside seat foldable for access to third-row seating
- Third-row bench seat with fold and stow facility
- Head restraints to all seats
- Punch cloth seat trim
- Full-length, soft-trimmed headlining
- Half-height interior side panelling
- Rubber floor covering
- Tinted glass
- Nearside and offside sliding side-access doors
- Fixed side windows fitted to nearside and offside sliding doors
- Tailgate with heated window and wash/wipe facility
- Full-diameter flush wheel covers

## Combi folding third-row seat

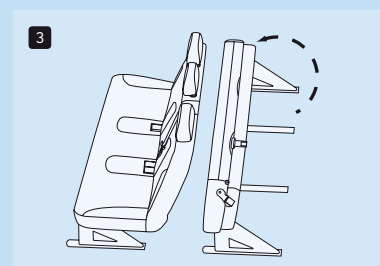
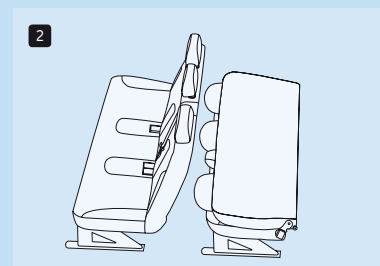
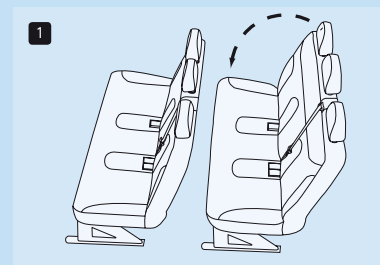

Combi's 'stow and fold' third-row seats (1-3) convert the 9-seat Combi into a six seater with additional luggage space, without having to remove any seats from the vehicle.



## Doublecab SWB

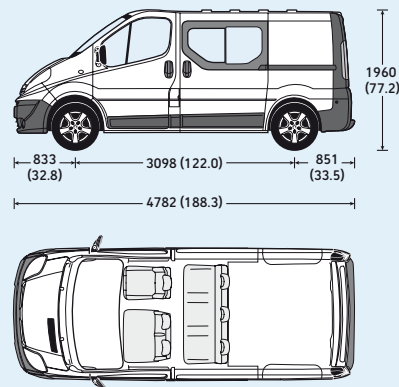

Measurements are shown in millimetres (inches). Height shown unladen.

## Doublecab LWB

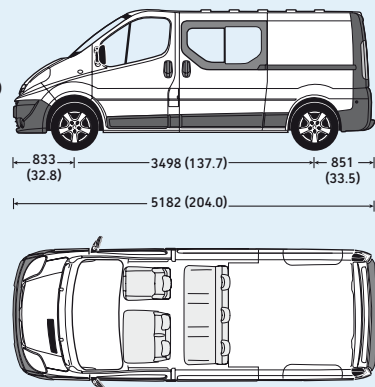

### Doublecab highlights\*

- Driver's airbag
- Inertia-reel lap and diagonal seatbelts
- Anti-lock Braking System (ABS)
- Emergency Brake Assist (EBA)
- Remote control central deadlocking
- Rev counter
- Steering column adjustable for reach
- Facia-mounted gear lever
- CD player with MP3 format/stereo radio/auxiliary-in socket/integrated display (CD 10)
- Steering column mounted audio controls
- Six-way adjustable driver's seat
- Dual front passengers' bench seat
- Three-passenger individually contoured rear bench seat
- Head restraints to all seats
- Punch cloth seat trim
- Full-height ABS plastic bulkhead with window
- Tinted glass
- Twin sliding side-access doors with sliding windows
- Unglazed rear doors
- Full-diameter flush wheel covers

### Doublecab Sportive highlights\*

As Doublecab with the following additions/changes:

- Electric Pack: electrically operated front windows and electrically adjustable/heated door mirrors
- Multi-function trip computer (provides information on fuel used, overall distance, average and instantaneous fuel consumption, remaining range, distance before service and average speed. Plus additional driver information messages as detailed in the owner's manual)
- Driver's seat with lumbar adjustment and armrest
- Remote control ultrasonic security alarm system
- Air conditioning
- CD player with MP3 format/stereo radio/auxiliary-in socket/Bluetooth® connectivity for compatible mobile phones/remote monochromatic display (CD 30)
- 16-inch alloy wheels
- Two-coat metallic or pearlescent paint

### Options at extra cost

Please note: some of the options listed are not available on every model. Please consult the current Commercial Vehicle and Accessory Price Guide for specific option availability. This can be found online at: [www.vauxhall.co.uk](http://www.vauxhall.co.uk)

#### Option packs

- Vision Pack: Rain-sensitive windscreen wipers, automatic lighting control, front fog lights, selective door locking
- Electric Pack: Electrically operated front windows and electrically adjustable/heated door mirrors
- Smoker Pack: Cigar lighter, front ashtray

#### Safety and security options

- Front passengers' twin airbag
- Electronic Stability Programme-plus (ESP-plus)
- Remote control ultrasonic security alarm system

#### Interior and seating options\*

- Driver's seat with lumbar adjustment and armrest
- Driver's seat and single front passenger's seat with lumbar adjustment and armrest
- Air conditioning – cab area only
- Front and rear air conditioning
- Solar Reflect® windscreen
- Additional rear heating
- Cruise control
- Leather-covered steering wheel with cruise control
- FlexxCargo anchorage

#### Mechanical options

- Speed limiter
- Digital tachograph (mandates CD 10 CD player/stereo radio on Sportive models)\*\*
- Tow bar with seven-pin electrics†

#### Exterior options

- Sliding windows in nearside and offside sliding side-access doors
- 16-inch alloy wheels (steel spare) with 215/65 R 16 tyres

- Two-coat metallic or pearlescent paint
- Special paint (restrictions apply – please consult your retailer for availability)
- Rear parking distance sensors
- 250° opening unglazed rear doors
- 250° opening glazed rear doors
- Glazed rear doors with heated windows and wash/wipe facility
- Tailgate with heated window and wash/wipe facility
- Tyre inflation kit in lieu of spare wheel

#### Audio, communication and navigation options

Please consult your Vauxhall Commercial Vehicle retailer for more information regarding the current availability of the audio units featured in this brochure.

- CD 30 BT, CD player with MP3 format, AM/FM stereo radio, auxiliary-in socket, Bluetooth® connectivity for compatible mobile phones, remote monochromatic display, two 20-watt speakers, steering column mounted audio controls
- CD 30 BT USB, as above with USB connection
- CD 30 BT NAVI, satellite navigation system with remote colour monitor, CD player with MP3 format, AM/FM stereo radio, auxiliary-in socket, Bluetooth® connectivity for compatible mobile phones, two 20-watt speakers, steering column mounted audio controls
- CD 30 BT NAVI USB, as above with USB connection

\* = Please refer to the owner's manual regarding the correct fitment of child seats and safe carriage of children.

\*\* = Digital tachograph is not available with optional audio units. The digital tachograph option must be specified at time of ordering as it cannot be fitted retrospectively and requires calibration at an approved tachograph centre within 14 days of the vehicle's registration. The legislation regarding the use of tachographs is complex and operators should seek independent advice or speak to the CV specialist within a Vauxhall Commercial Vehicle retailer to ensure compliance. Alternatively your local DVLA office will also be able to provide clarification of the relevant legislation.

† = Unless the user qualifies for a specific exemption, vehicles operated with a trailer, where the combined weight of the vehicle, trailer and payload exceeds 3500kg, will need a digital tachograph.



**90PS/  
115PS**  
2.0CDTI 16v  
common rail  
diesel engine



**146PS**  
2.5CDTI 16v  
common rail  
diesel engine

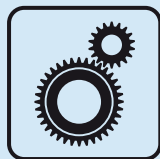

**Tecshift**  
Six-speed  
transmission  
optional on the  
2.0CDTI 16v(115PS)  
and 2.5CDTI 16v  
engines

## Power and torque

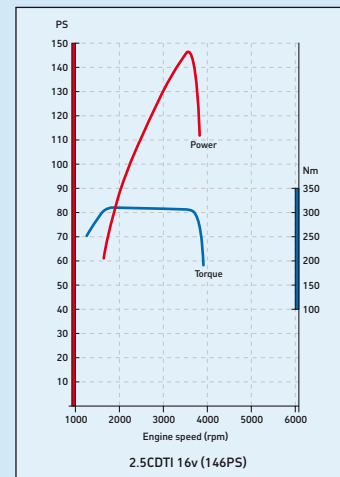
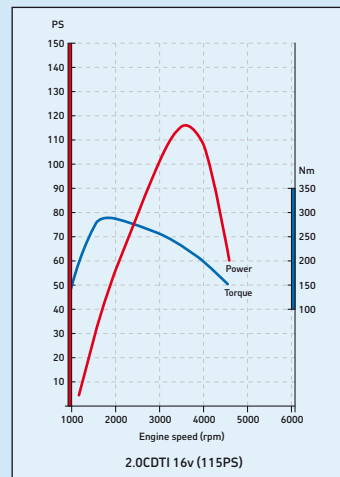
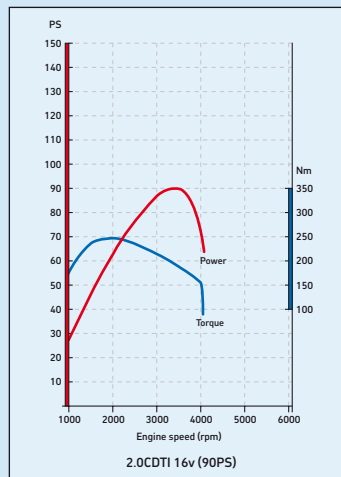

## Engines

|                       | 2.0CDTI 16v (90PS)   | 2.0CDTI 16v (115PS)          | 2.5CDTI 16v (146PS)   |
|-----------------------|--|------------------------------|---|
| Fuel type             | Diesel   | Diesel                       | Diesel  |
| Capacity              | 1995cc   | 1995cc                       | 2464cc  |
| Maximum power         | 90PS (66kW) @ 3500rpm  | 115PS (84kW) @ 3500rpm       | 146PS (107kW) @ 3500rpm   |
| Maximum torque        | 240Nm (177 lb.ft.) @ 1500rpm   | 290Nm (214 lb.ft.) @ 1600rpm | 320Nm (236 lb.ft.) @ 1500rpm  |
| Configuration         | 4 cylinders, 4 valves per cylinder, double overhead camshafts              |                              |   |
| Emission compliance   | Euro 4   |                              |   |
| Fuel/induction system | Fixed geometry turbocharger and intercooler.<br>Common rail fuel injection |                              | Variable geometry turbocharger and<br>intercooler. Common rail fuel injection |
| Service interval      | 20,000 miles or one-year (whichever occurs sooner)                         |                              |   |



## Fuel economy and emissions

|                              | Fuel economy mpg (litres/100km) |                     |                 | CO <sub>2</sub><br>(g/km) |
|------------------------------|---------------------------------|---------------------|-----------------|---------------------------|
|                              | Urban driving                   | Extra-urban driving | Combined figure |                           |
| <b>Combi SWB/LWB</b>         |                                 |                     |                 |                           |
| 2.0CDTI 16v (90/115PS)       | 30.7 (9.2)                      | 41.5 (6.8)          | 36.7 (7.7)      | 203                       |
| 2.0CDTI 16v (115PS) Tecshift | 33.2 (8.5)                      | 40.4 (7.0)          | 37.7 (7.5)      | 199                       |
| <b>Doublecab SWB/LWB</b>     |                                 |                     |                 |                           |
| 2.0CDTI (90/115PS)           | 33.2 (8.5)                      | 42.8 (6.6)          | 38.7 (7.3)      | 195                       |
| 2.0CDTI (115PS) Tecshift     | 35.8 (7.9)                      | 41.5 (6.8)          | 39.2 (7.2)      | 192                       |
| 2.5CDTI                      | 27.2 (10.4)                     | 37.2 (7.6)          | 32.5 (8.7)      | 229                       |
| 2.5CDTI Tecshift             | 31.0 (9.1)                      | 35.8 (7.9)          | 34.0 (8.3)      | 220                       |

Fuel consumption and CO<sub>2</sub> emission data complies with the relevant EU regulations. **Important:** the results given relate to the particular vehicle tested; inevitably there are differences between individual vehicles of the same model. Driving style, road and traffic conditions, vehicle mileage and standard of maintenance may also affect fuel consumption.

### Transmission

- Front-wheel drive
- Six-speed manual gearbox
- Six-speed Tecshift transmission (available at extra-cost)

### Steering

- Power-assisted rack and pinion system
- Turning circle (kerb-to-kerb):  
SWB – 11.84m (38.8 ft.)  
LWB – 13.17m (43.2 ft.)
- Turns lock-to-lock: 3.3

### Suspension

**Front:** Independent wishbones with MacPherson spring struts, control arms and separate galvanised, double isolated, vibration reducing subframe.

**Rear:** Semi-independent with trailing links, progressive-rate mini-block coil springs with rubber bump-stops and telescopic, load-adaptable gas-pressure dampers.

### Brakes

**Front ventilated disc brakes:**

305mm diameter.

**Rear disc brakes:**

280mm diameter.

### Wheels and tyres

- 16-inch steel wheels with full-diameter flush covers and 205/65 R 16 tyres (All models excluding Doublecab 2.5CDTI/Sportive)
- 16-inch steel wheels with full-diameter flush covers and 215/65 R 16 tyres (Doublecab 2.5CDTI)
- 16-inch alloy wheels with 215/65 R 16 tyres (Doublecab Sportive)
- Full-size spare wheel

### Fuel tank capacity

- 90 litres (19.8 gallons)

### Vauxhall Assistance and warranties\*

- All new Vivaros qualify for a three-year vehicle warranty consisting of a one-year/unlimited mileage manufacturer's warranty and a second and third year manufacturer's warranty with a 100,000 miles limitation
- Vauxhall Assistance for 12 months from first registration
- Six years' body panel anti-perforation warranty

\* = Warranty is only available on vehicles sourced from General Motors UK Limited. Terms and conditions apply – please see your Vauxhall retailer for details.

## Weights kg

|                                   | Kerbweight | GVW  |
|-----------------------------------|------------|------|
| <b>Combi SWB</b>                  |            |      |
| 2.0CDTI 16v (90PS)                | 1893       | 2920 |
| <b>Combi LWB</b>                  |            |      |
| 2.0CDTI 16v (115PS)               | 1954       | 3040 |
| 2.0CDTI 16v (115PS) Tecshift      | 1968       | 3050 |
| <b>Doublecab SWB</b>              |            |      |
| 2900 2.0CDTI 16v (90PS/115PS)     | 1804       | 2935 |
| 2900 2.5CDTI 16v (146PS)          | 1852       | 2985 |
| 2900 2.0CDTI 16v (115PS) Sportive | 1841       | 2935 |
| 2900 2.5CDTI 16v (146PS) Sportive | 1889       | 2985 |
| <b>Doublecab LWB</b>              |            |      |
| 2900 2.0CDTI 16v (90PS/115PS)     | 1840       | 2960 |
| 2900 2.5CDTI 16v (146PS)          | 1887       | 3035 |
| 2900 2.0CDTI 16v (115PS) Sportive | 1877       | 2960 |
| 2900 2.5CDTI 16v (146PS) Sportive | 1924       | 3035 |

**Please note:** Tecshift transmission is available at extra cost on Doublecab 2.0CDTI 16v (115PS) and 2.5CDTI (146PS) engines, please deduct 8kg from kerbweight figures. **Kerbweights** for standard vehicles include coolant, oil, 90% full fuel tank and spare wheel. They will vary according to the vehicle specification (including options and accessories) with a corresponding variation in payload. **Gross plated weights** (including axle weights) quoted on the vehicle plate must never be exceeded. **Roof load** maximum 200kg (includes weight of roof carrier) when Vauxhall approved carrier system used. **Towing weights** (where applicable) should not exceed 750kg (unbraked trailer) or 2000kg (braked trailer).

## Load area volumes cu.m (cu.ft.)

|                               | SWB        | LWB         |
|-------------------------------|------------|-------------|
| Combi (with luggage cover)    | N/A        | 1.1 (38.8)  |
| Combi (without luggage cover) | 1.2 (42.4) | 2.1 (74.2)  |
| Combi (folded rear bench)     | 2.5 (88.3) | 3.5 (123.6) |
| Doublecab                     | 3.3 (116)  | 4.2 (148)   |

# Trust Vauxhall

## **Protecting the environment**

Vauxhall's commitment to the environment is demonstrated by our products' many environmental awards, won both through the use of more recycled materials and by becoming cleaner and more efficient. For information on Vauxhall's efforts to achieve an environmentally sustainable future, see [www.vauxhall.co.uk/recycling](http://www.vauxhall.co.uk/recycling)

## **Fleet Customer Services**

Our dedicated support services for fleet managers includes factory demonstrators and information on whole life costs, company car and van taxation and finance. For further information please call **0870 010 0651**.

## **Vauxhall Extended Warranty**

For complete peace of mind Vauxhall offers an extended warranty that can be purchased on an annual basis following the expiry of the original new vehicle warranty. It covers most mechanical and electrical components. Terms and conditions apply, for further details please contact your local Vauxhall Commercial Vehicle retailer.



When you have finished with this brochure please recycle it

## **Business Lease**

Business Lease, from GMAC, offers the versatility of a purchase-based finance plan, while making the most efficient use of tax and cash-flow benefits for VAT-registered business users. It's available for all Vauxhall Commercial Vehicles up to 12 months old and offers highly flexible term lengths, variable deposits and a choice of payment profiles. Ask your retailer for full details.

## **Business First**

Available to business users only, Business First enables you to drive a new vehicle without a large, initial financial outlay. You pay to use the vehicle, not to own it. The vehicle is provided over a predetermined period, and when that period comes to an end the vehicle is returned. Ask your retailer for full details.

## **Servicing and maintenance**

The best way to maximise the performance and reliability of your Vauxhall is to have all routine servicing and maintenance carried out at a Vauxhall Commercial Vehicle retailer. Nationwide there are over 250 light commercial vehicle retailers and a further 195 heavy commercial vehicle retailers.

## **In the event of an accident...**

Vauxhall Accident Support helps keep you mobile following an accident. Benefits include scene-of-accident advice, message service, assistance with claims and vehicle recovery. For further details call **0800 010 304**.

## **Premier Service Centres**

Our Premier Service Centres feature a guaranteed same day repair service (provided the parts are in stock) and an appointment-free service for diagnosis and repairs taking less than 90 minutes. All repairs are carried out within 24 hours of the diagnosis.

## **For more information...**

For a brochure on any Vauxhall model (up to a maximum of three per caller) or location of your nearest retailer, call **0845 600 1500**.

Alternatively, details can be found on our website at: [www.vauxhall.co.uk/vans](http://www.vauxhall.co.uk/vans)

Proud Sponsor of Home Nations Football



Every effort has been made to ensure that the contents of this publication were accurate and up-to-date at the time of going to press (April 2011). Vauxhall vehicles are equipped with components manufactured by various General Motors operating units and outside suppliers. The Company reserves the right to alter specifications and withdraw products from sale without notice. Any such alterations will be notified to Vauxhall retailers at the earliest opportunity; please consult your local retailer for the latest information. The specifications detailed within this brochure are not necessarily applicable to alternative models such as Special Editions. Details of any such models will be contained in specific literature or found on the Vauxhall website. Please note that Vauxhall retailers are not the agents of General Motors UK Limited and are not authorised to bind the Company by any specific or implied undertaking or representation. It is advisable to ensure that your motor insurance policy provides adequate cover for additional fitted options and accessories. Please note accessories shown are for illustrative purposes only. As part of Vauxhall's policy of environmental care, this brochure is printed on paper manufactured using Elemental Chlorine Free pulps from specially farmed, sustainable timber resources. All rights reserved. No part of this publication may be reproduced in any form or by any means, without the prior written permission of General Motors UK Limited.

VM1109392 ©2011 General Motors UK Limited Published April 2011 General Motors UK Limited, Luton LU1 3YT

**COMMERCIAL VEHICLES**  
*The Wheels of Business*



**VAUXHALL**